

NEONTM TILE



Experience
of natural surface...

Mfg. & Exporter Of :

- ▶ Wall Tiles
- ▶ Floor Tiles
- ▶ Vitrified Tiles
- ▶ Sanitary Wares

**DIGITAL
WALL TILES
300x600MM**

EXCLUSIVE

New Collection



GLOSSY FINISH
300X600mm



Glossy Finish

D.NO - SM-501

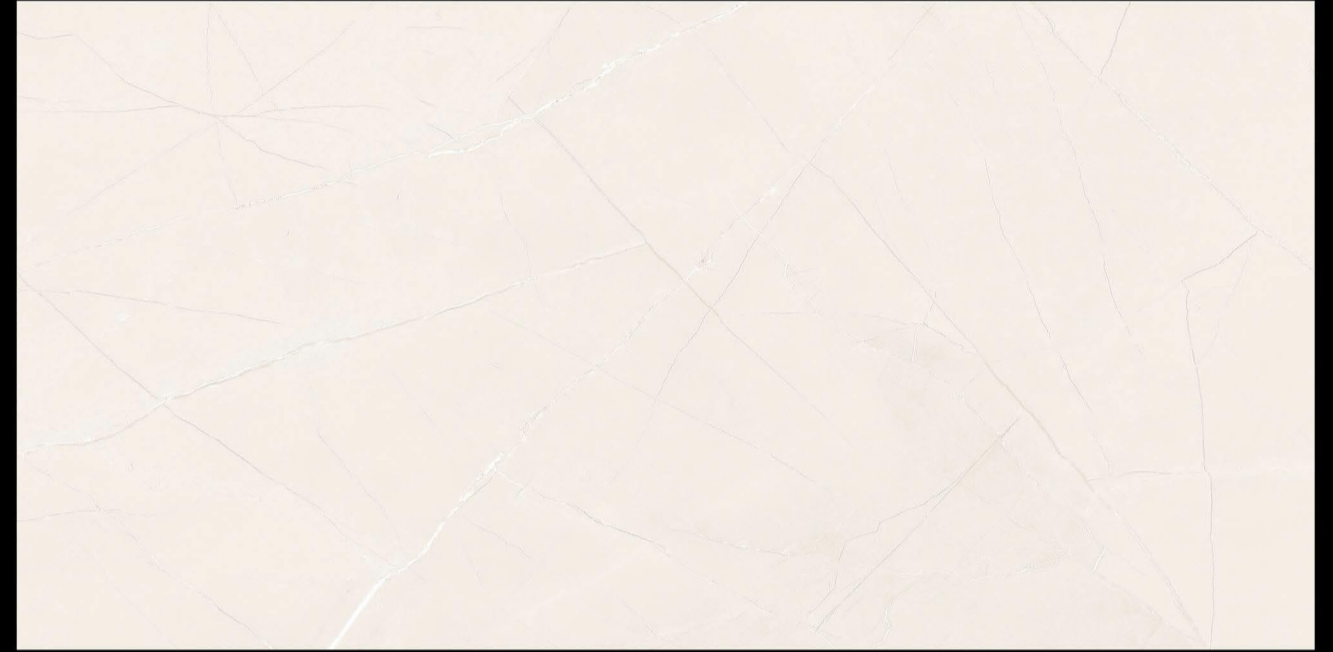
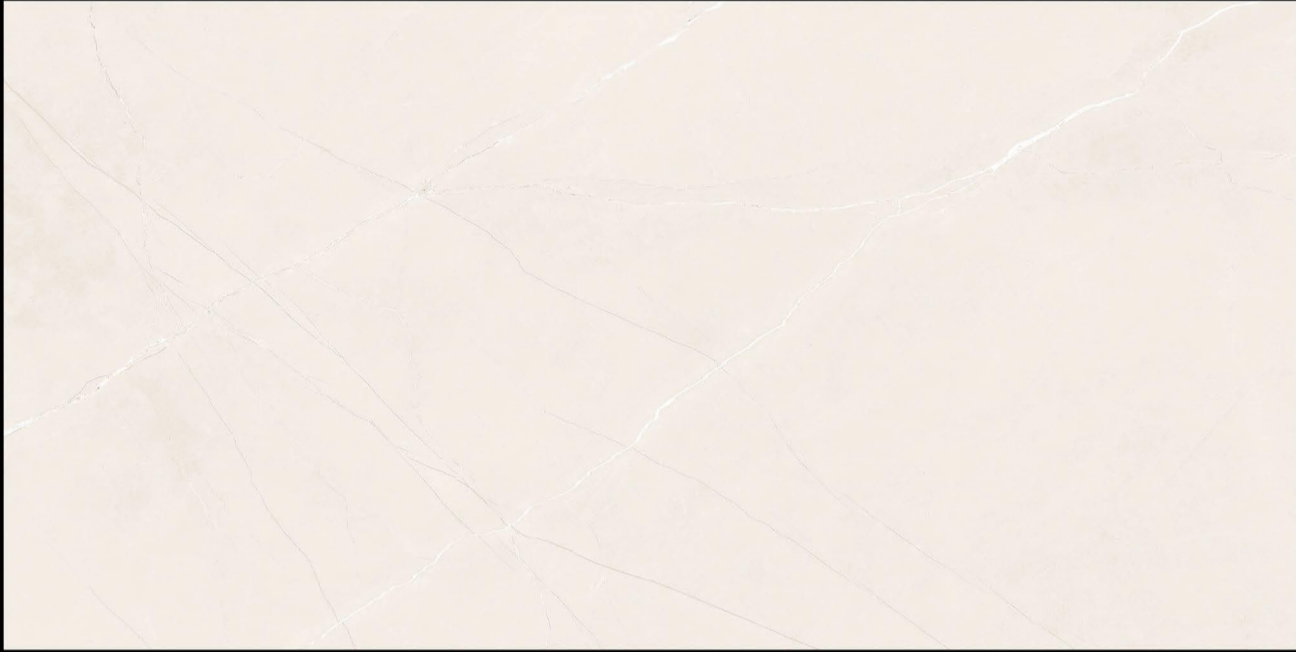

L

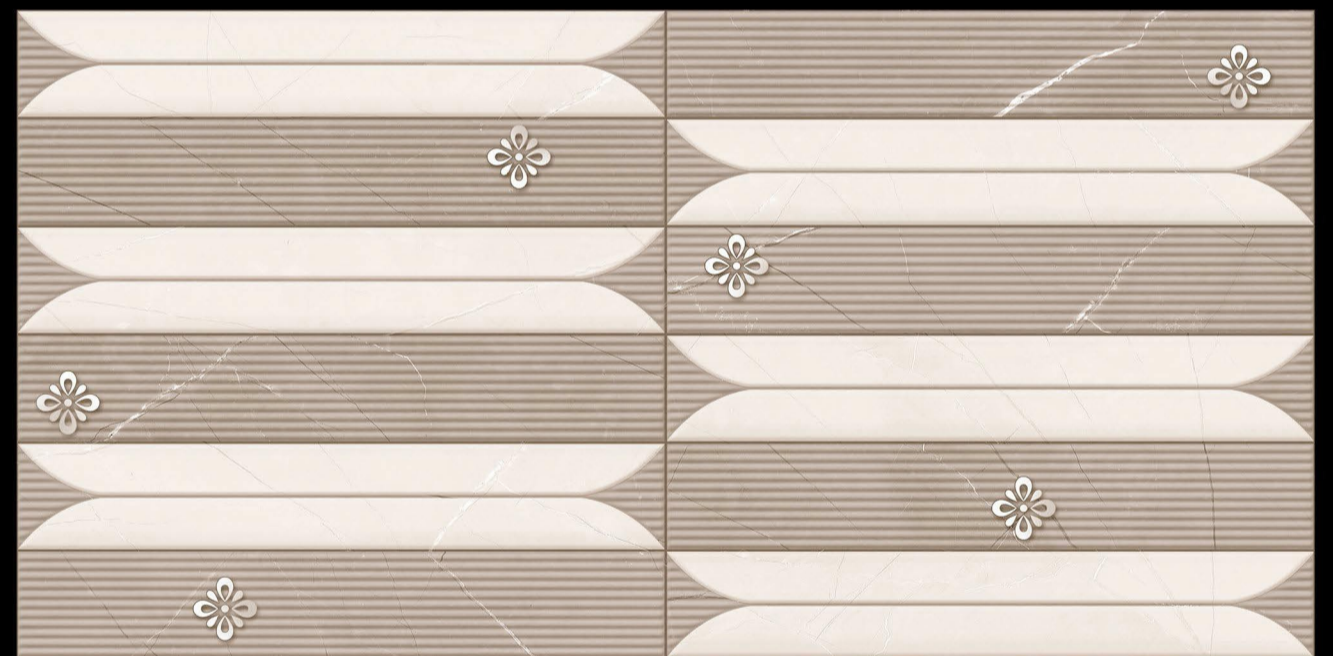
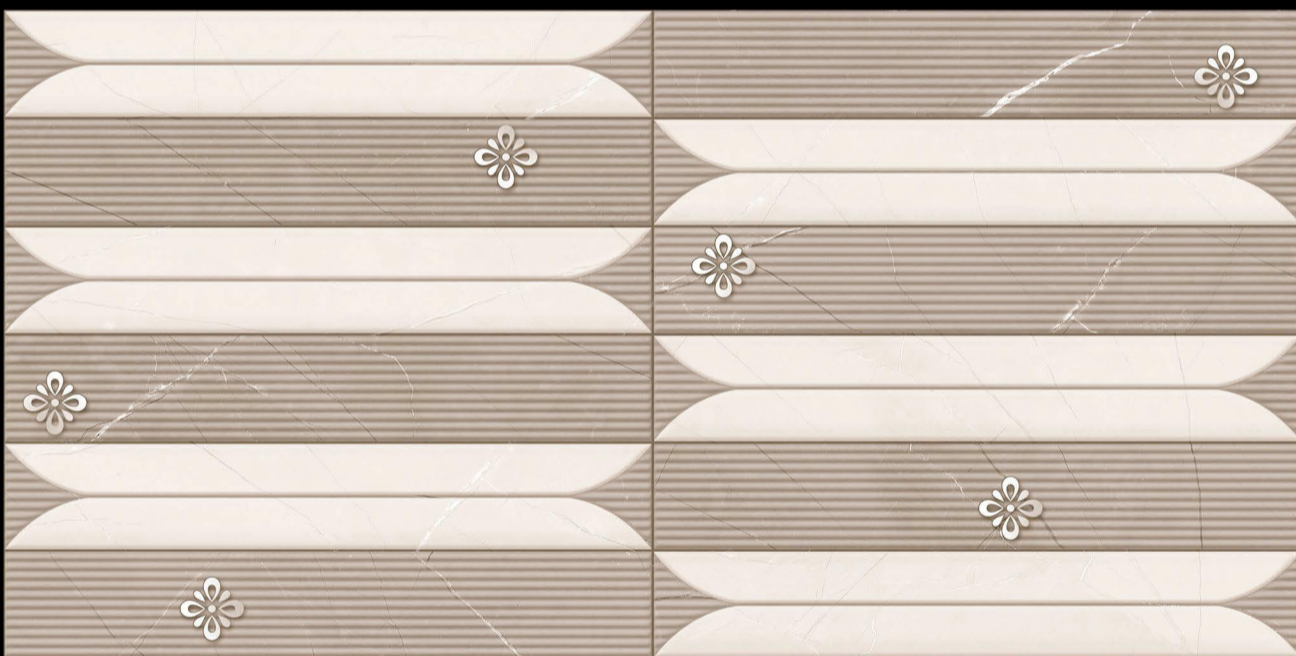

HL-2

HL-2

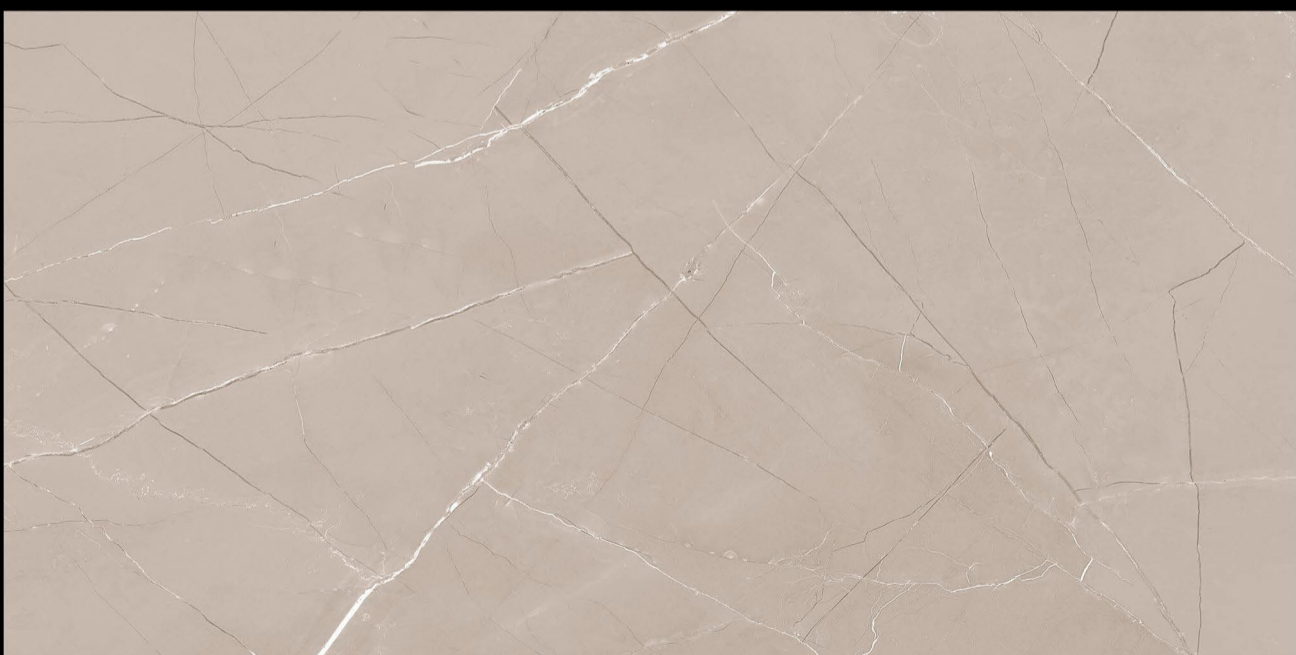

D



Glossy Finish

D.NO - SM-502



L

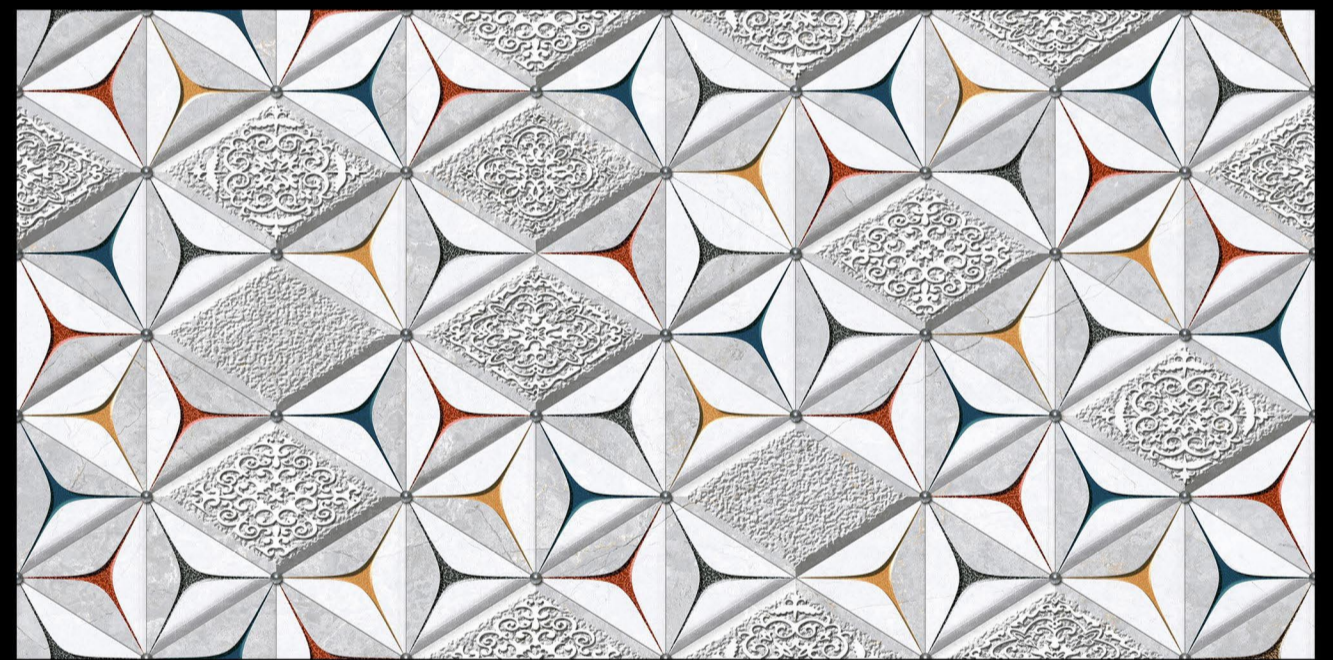
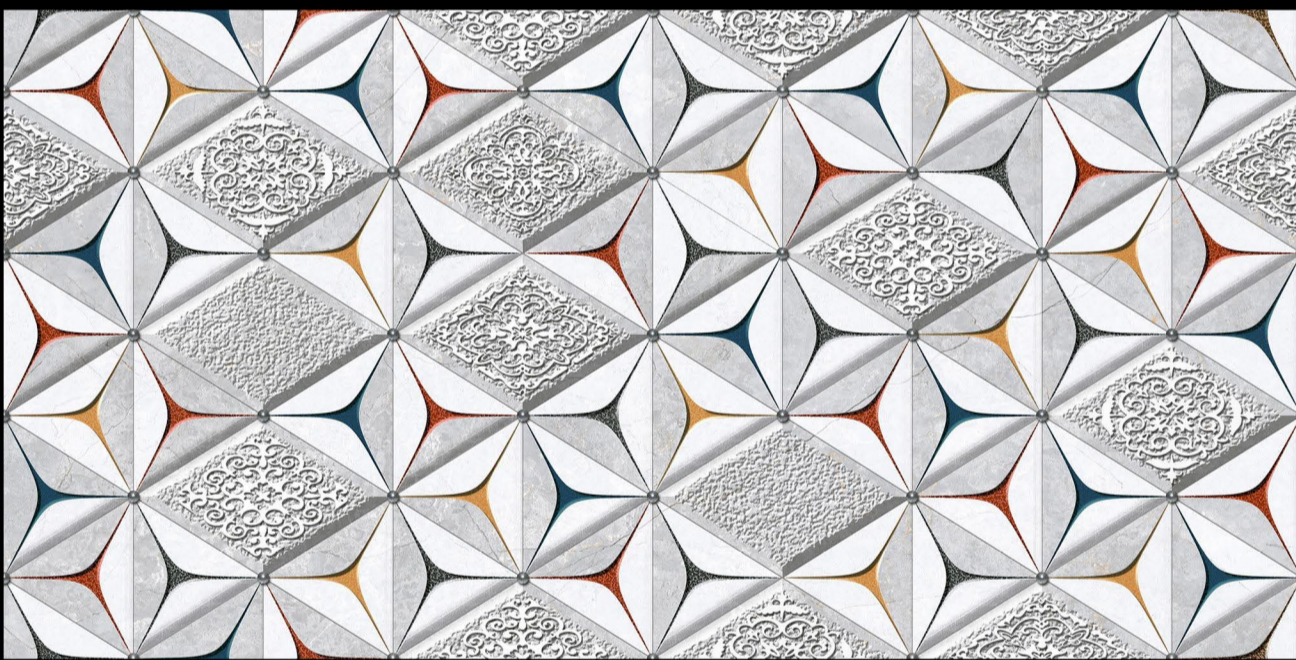

HL-1

HL-1



D



Glossy Finish

D.NO - SM-503



L



HL-2

HL-3

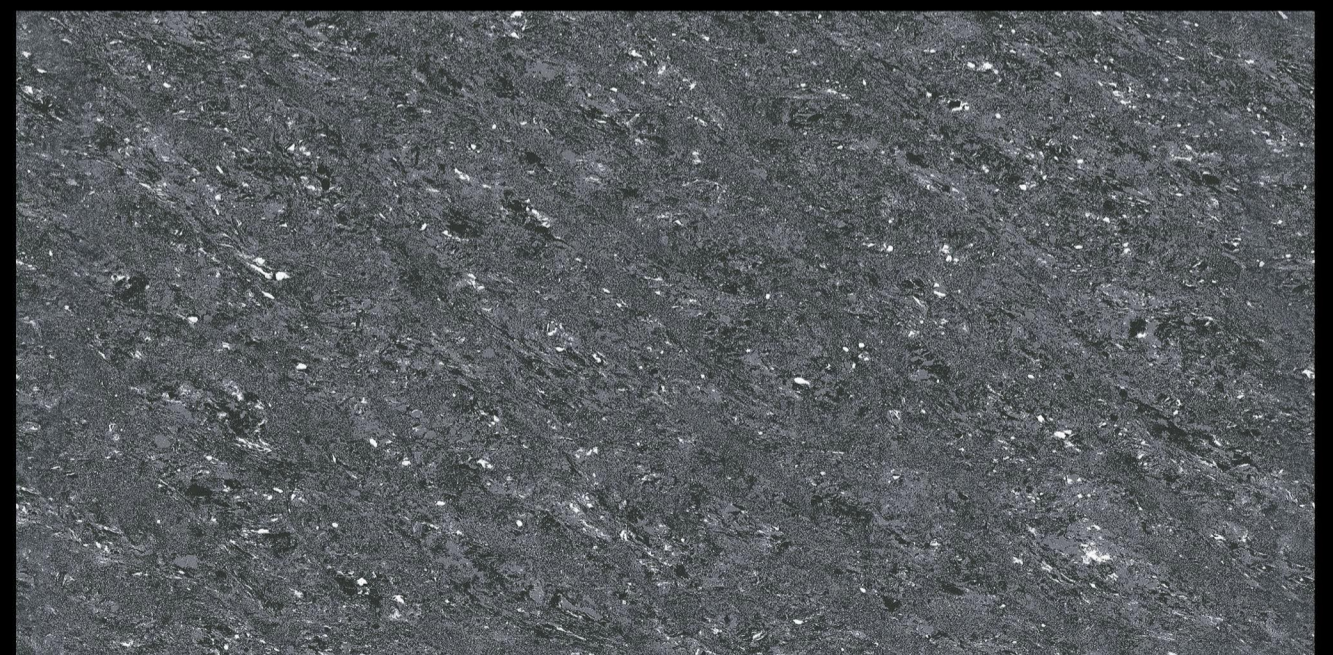
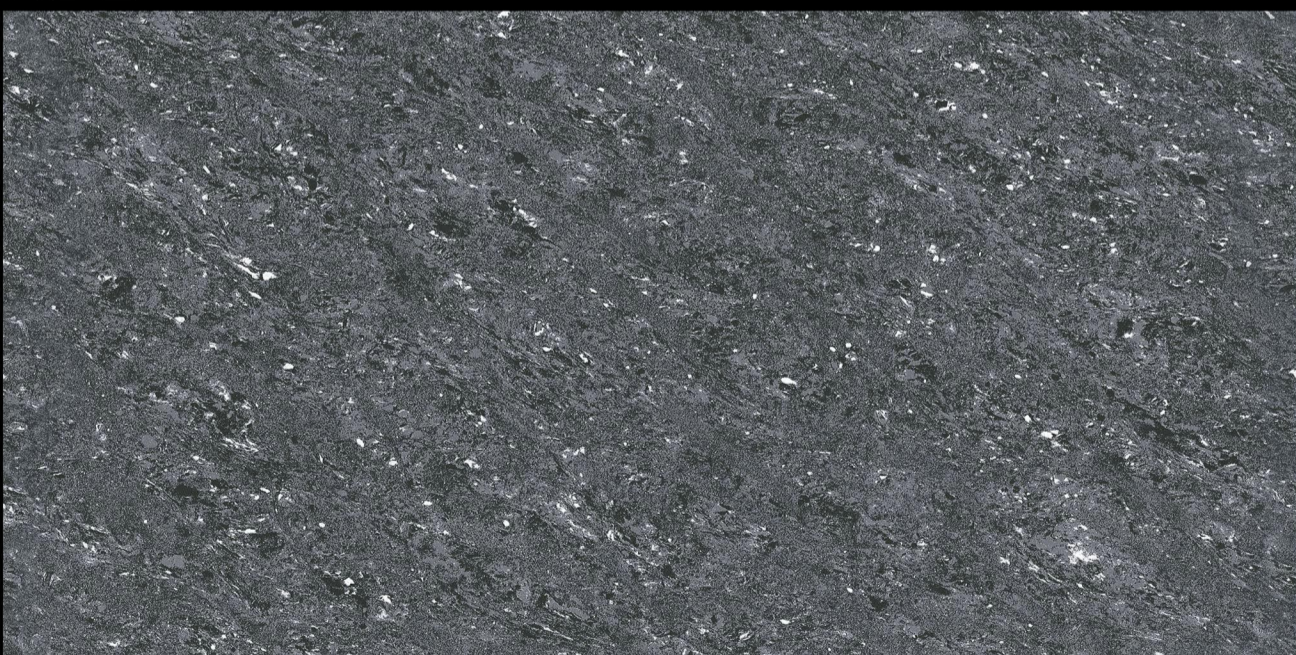

D



Glossy Finish

D.NO - SM-505



L

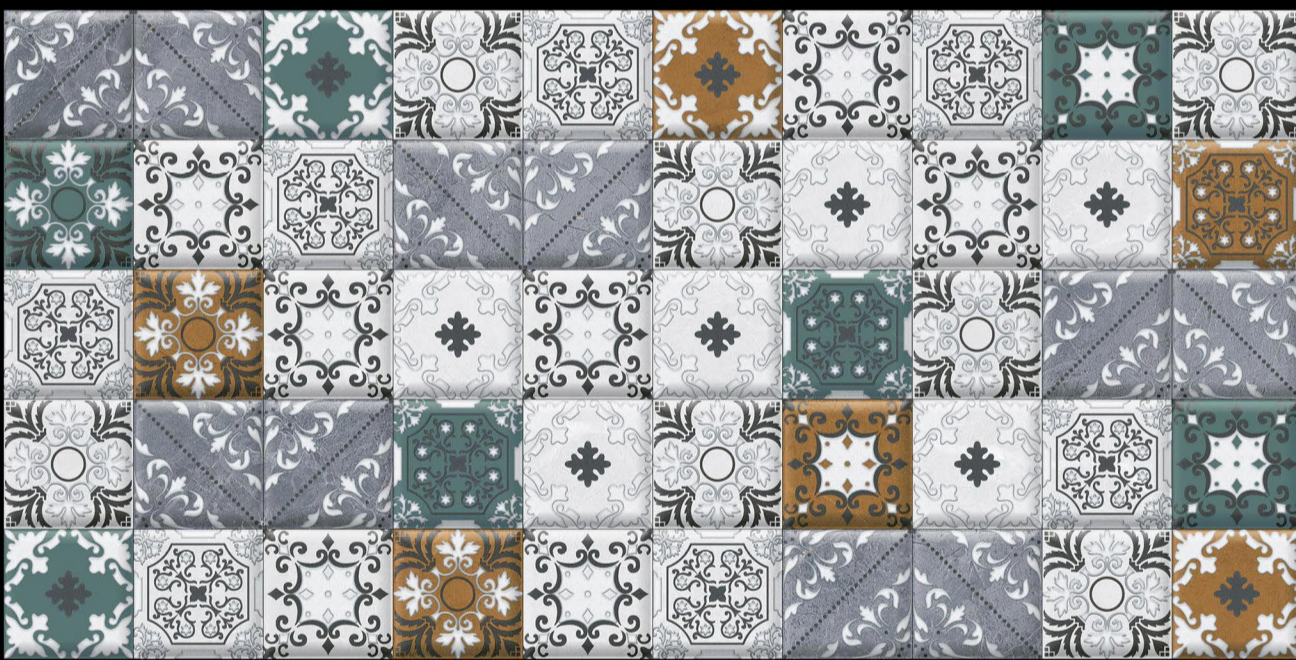

HL-3

HL-3



D



Glossy Finish

D.NO - SM-505



L

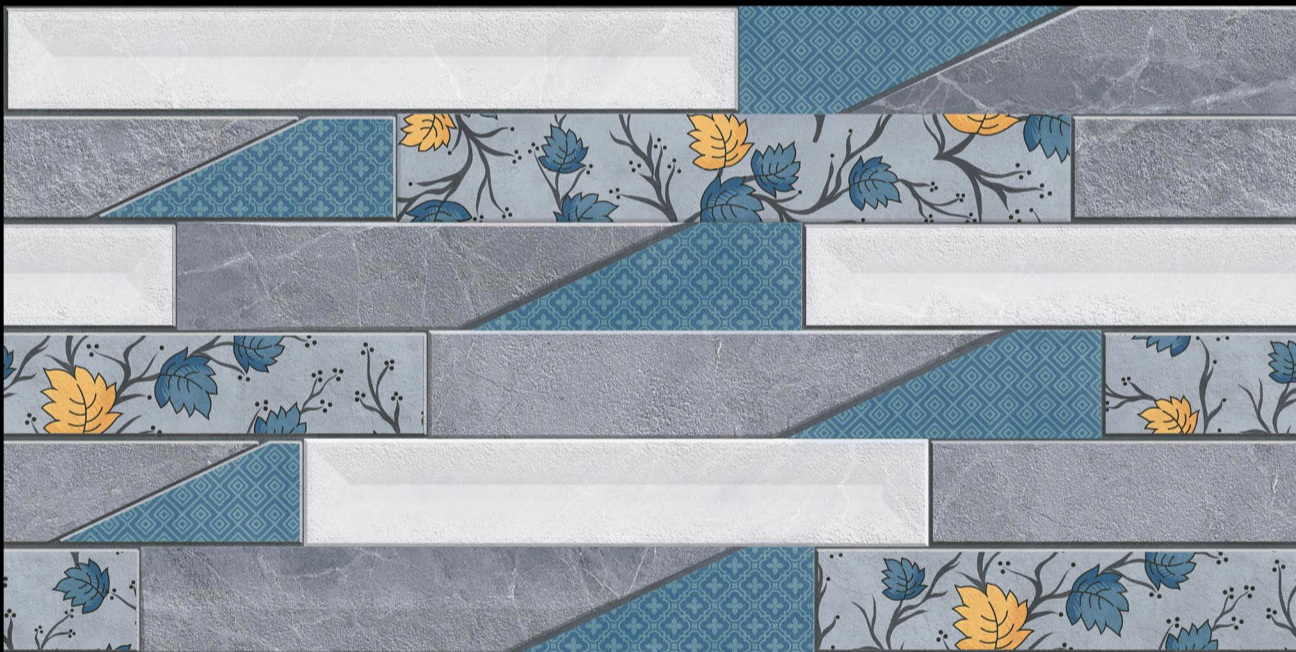

HL-1

HL-2



D



Glossy Finish

D.NO - SM-506



L



HL-1



L

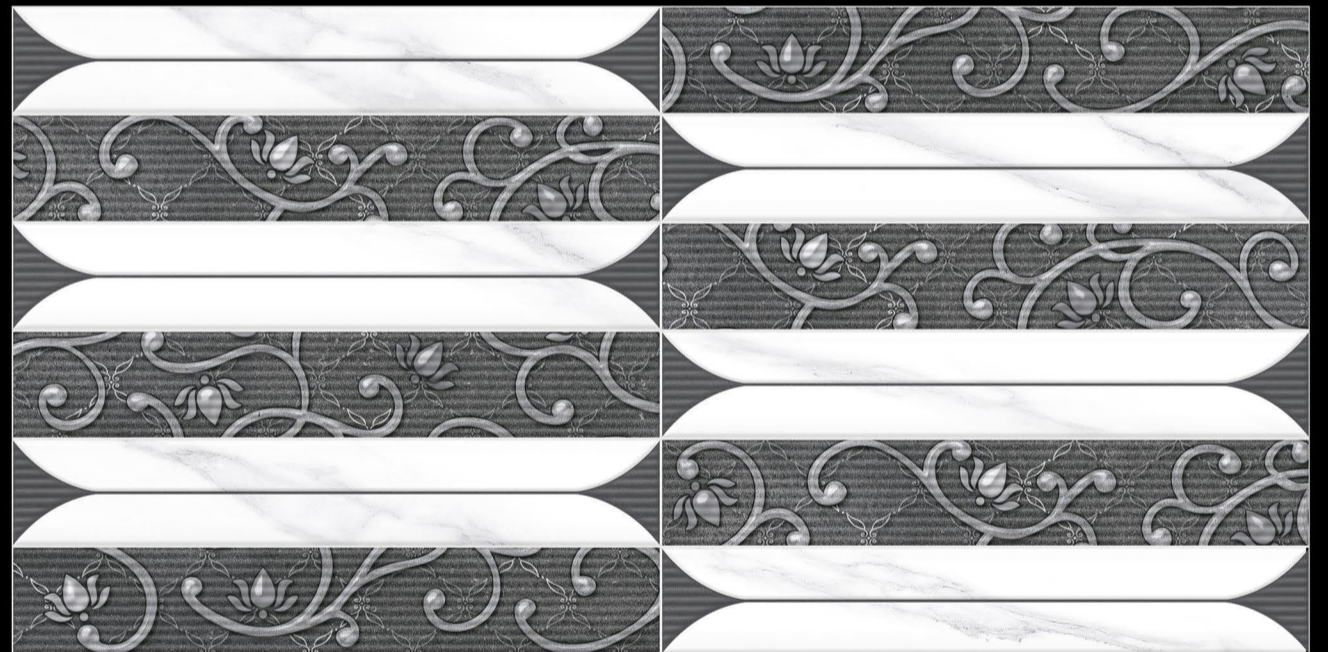

HL-2

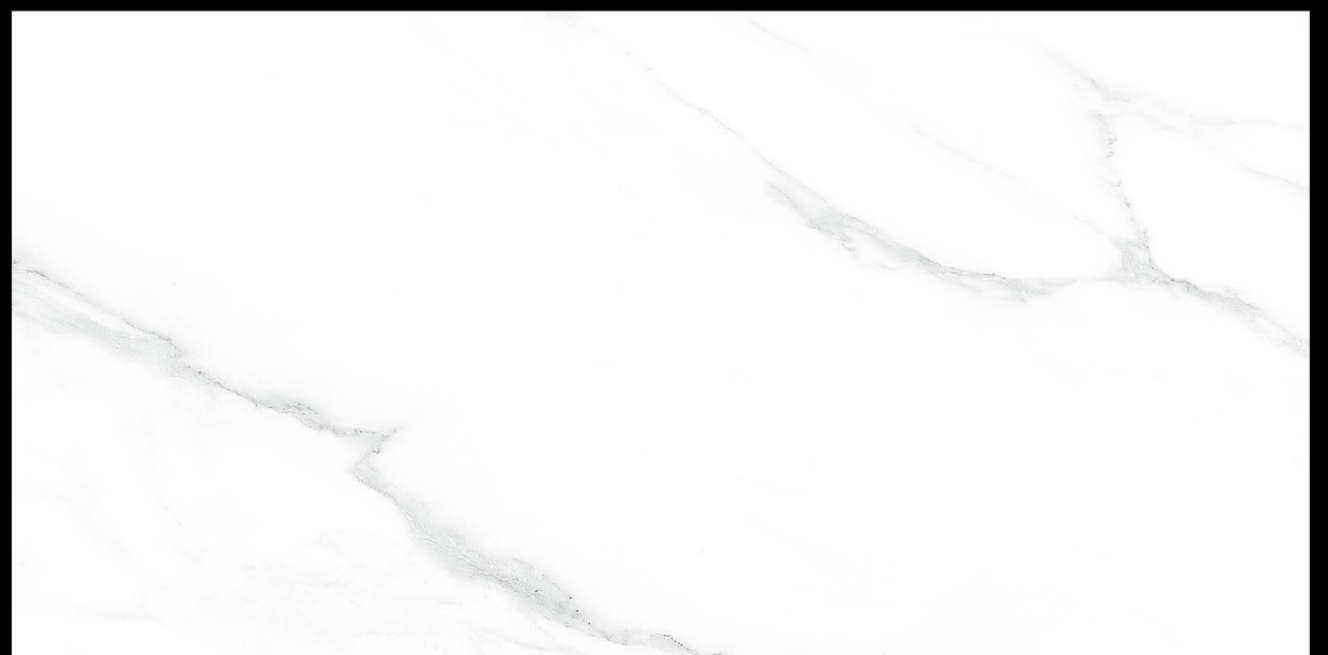

Glossy Finish

D.NO - SM-509

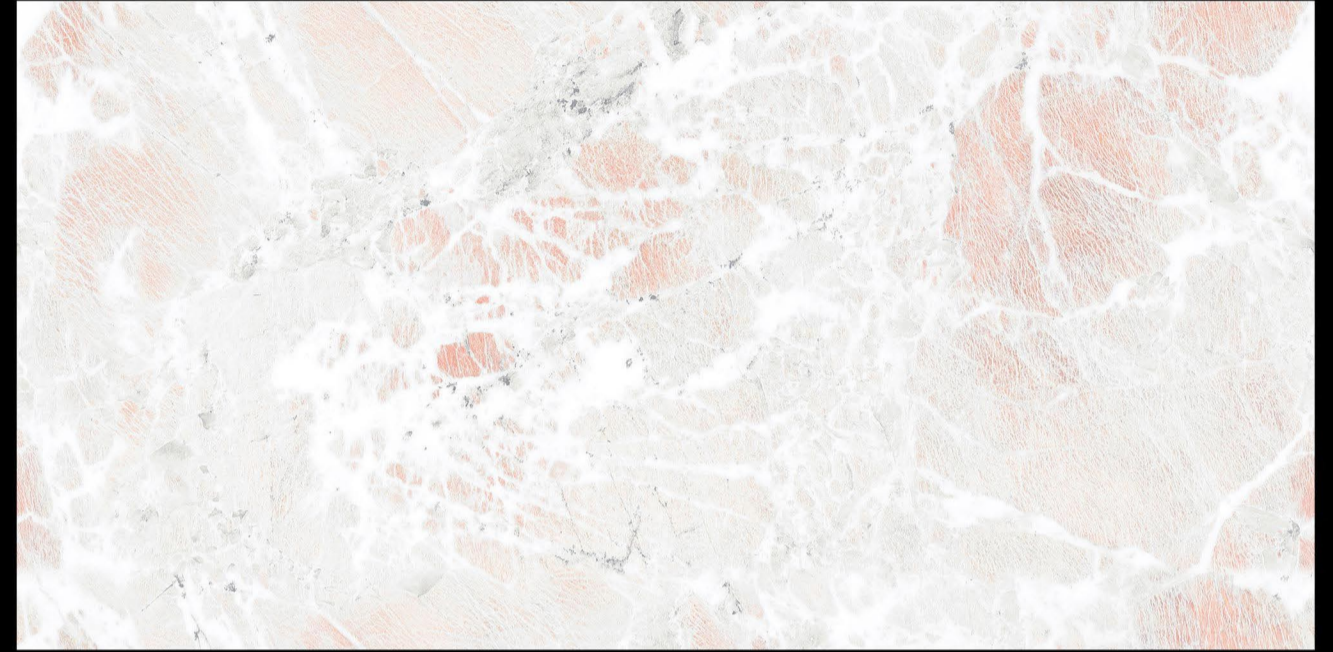

L

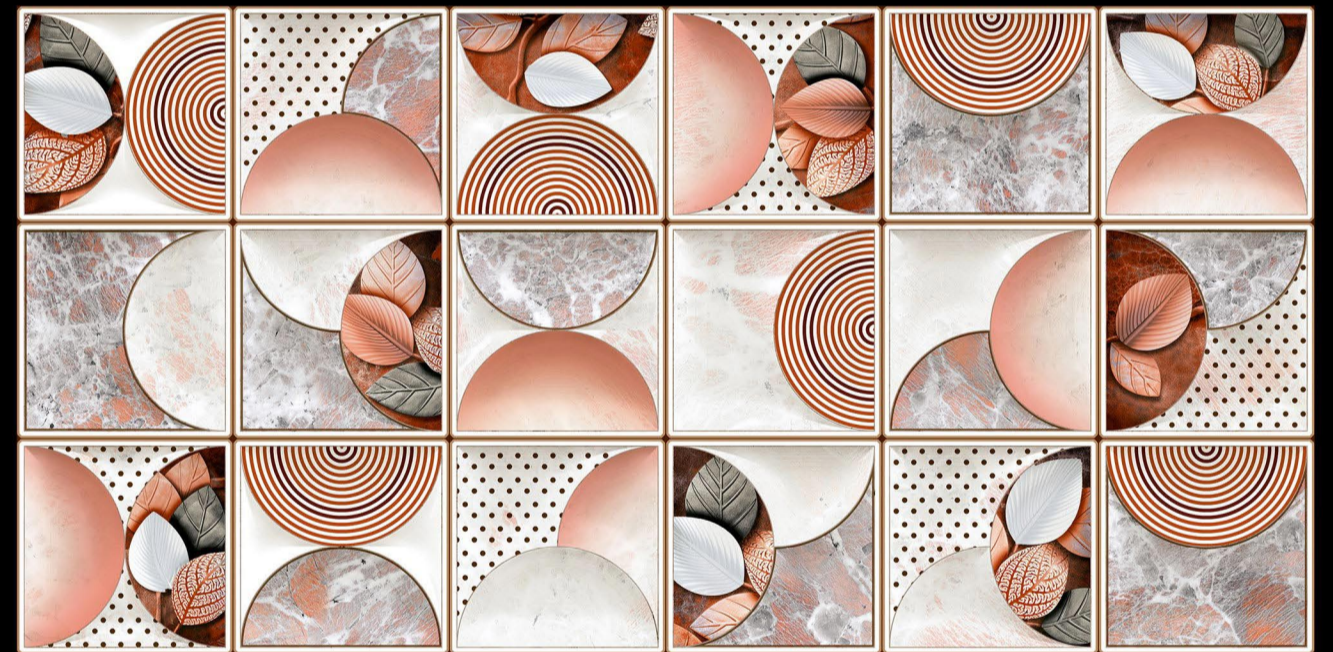

HL-1

HL-2

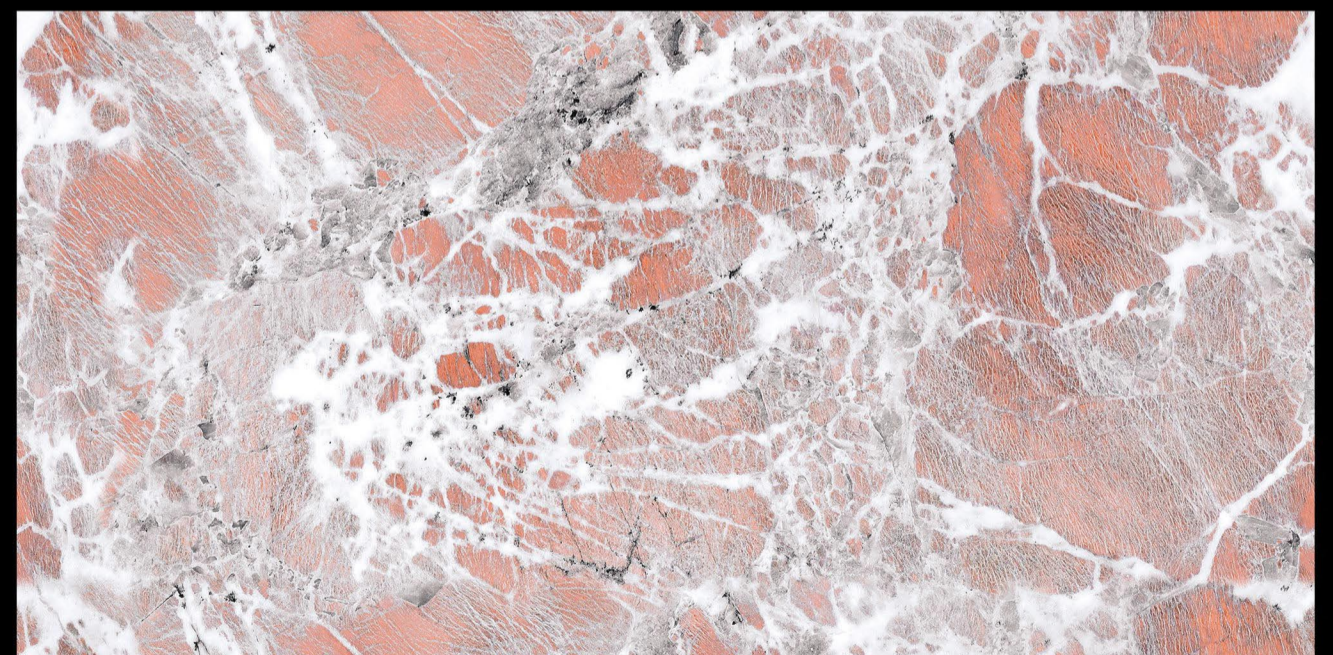
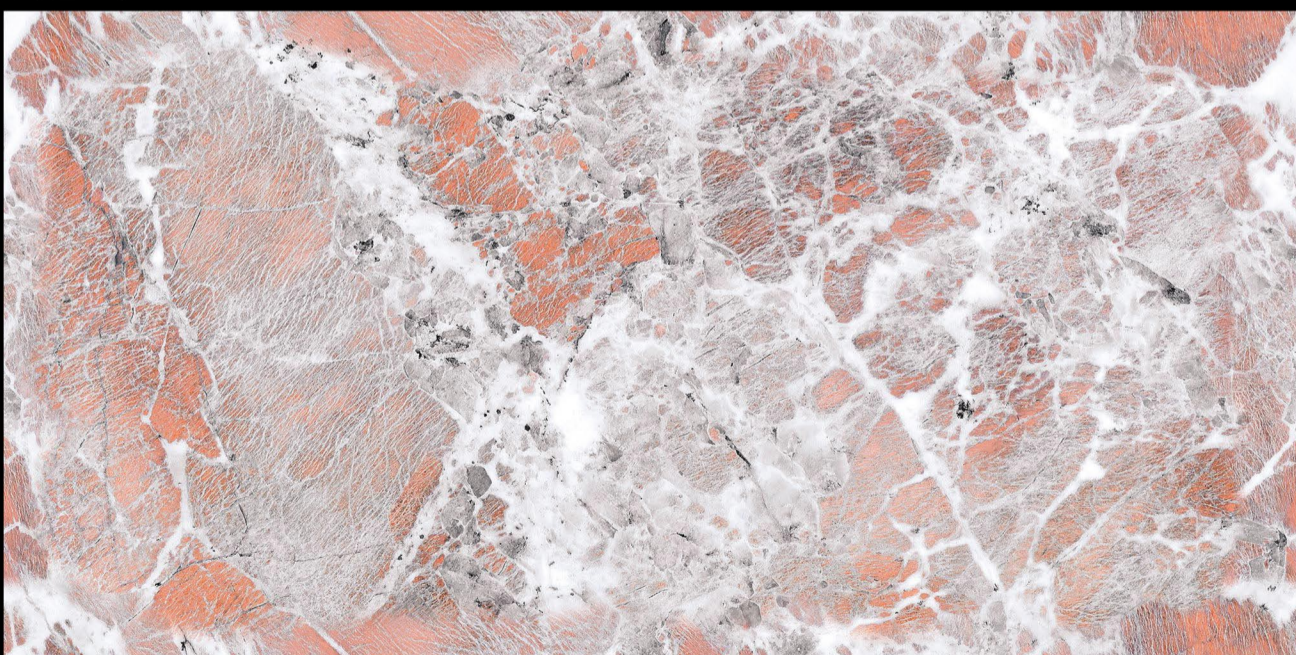

D



Glossy Finish

D.NO - SM-514



L



HL-1

HL-1

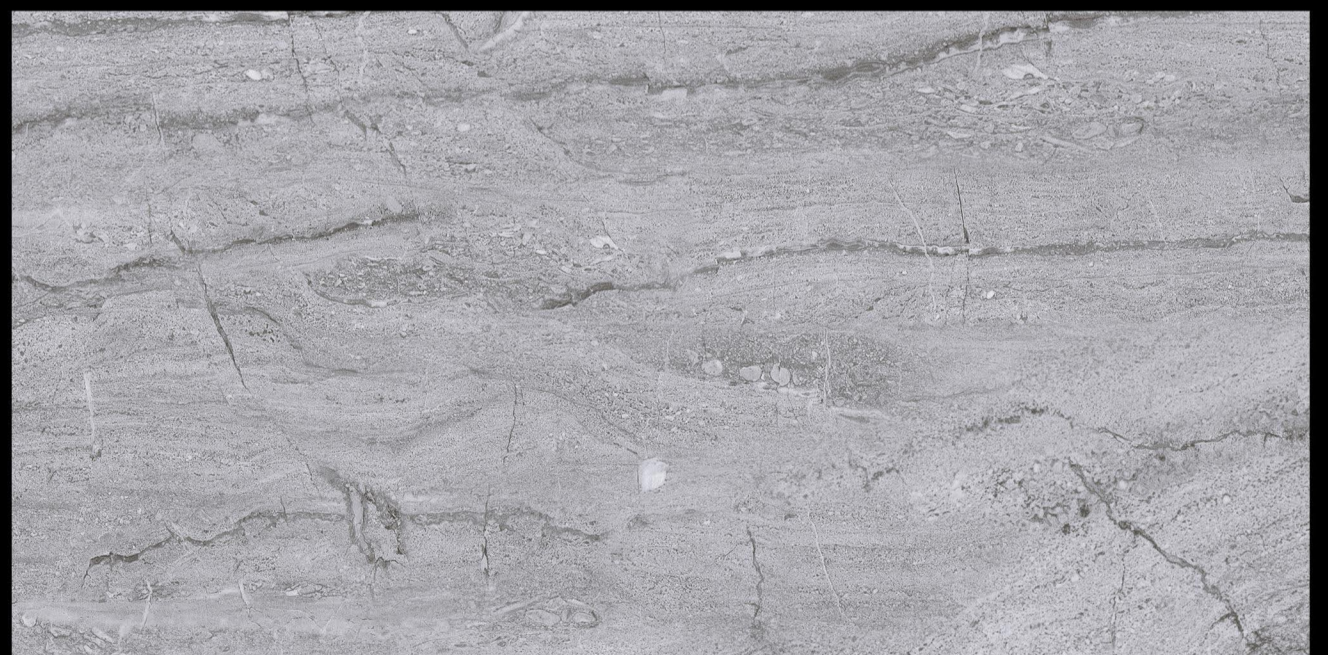
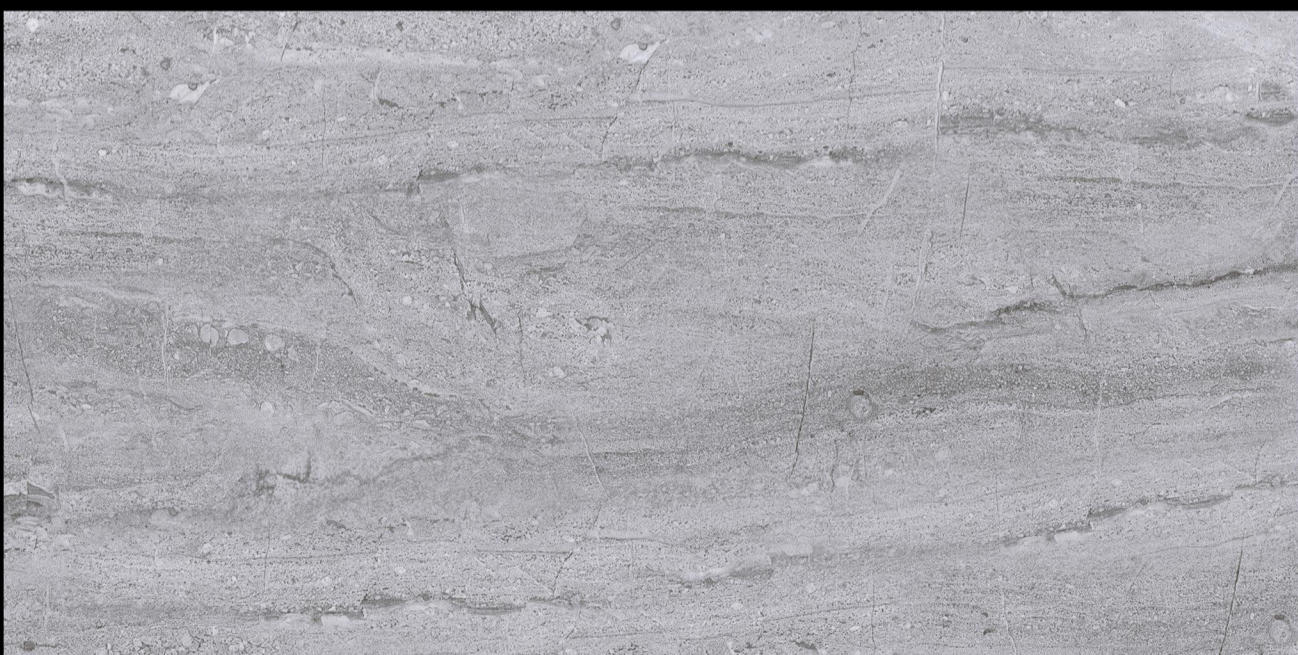

D



Glossy Finish

D.NO - SM-516

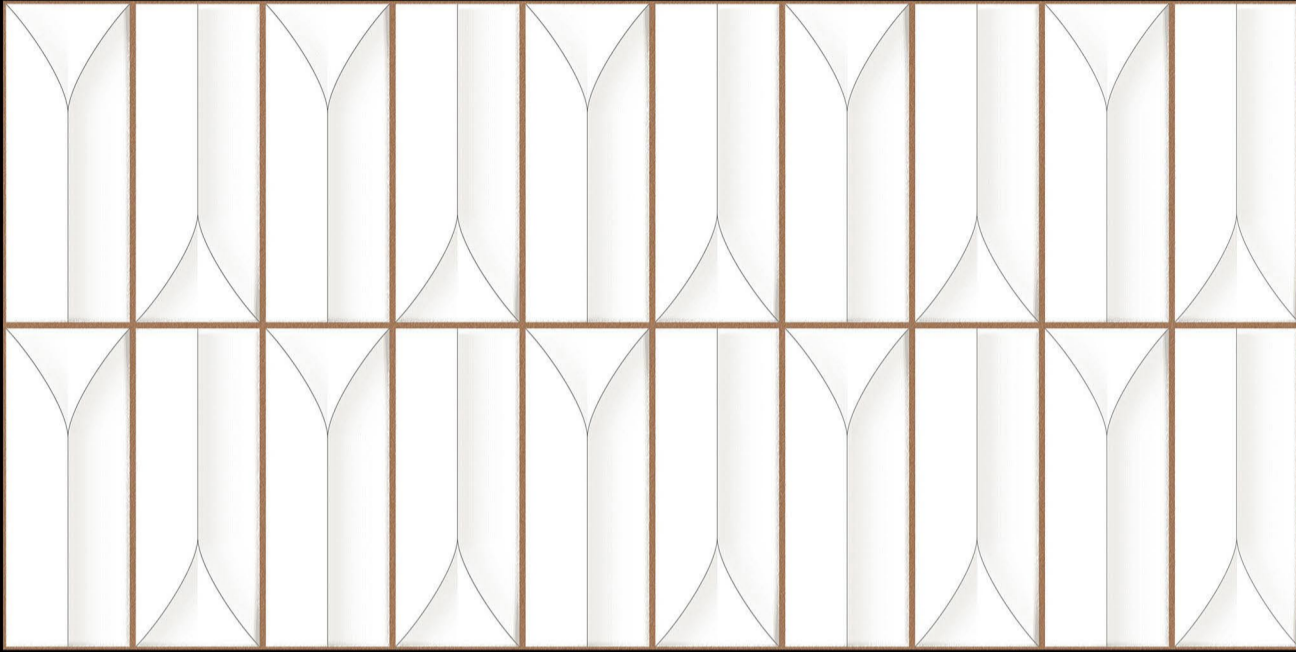

L

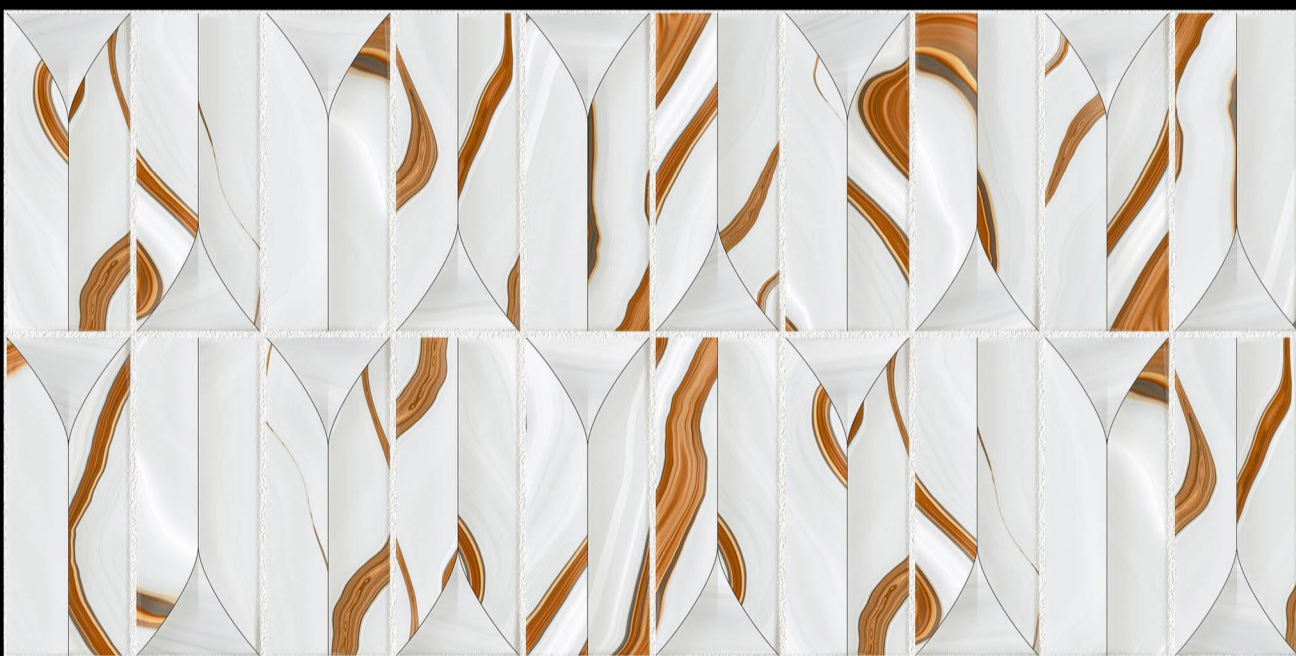
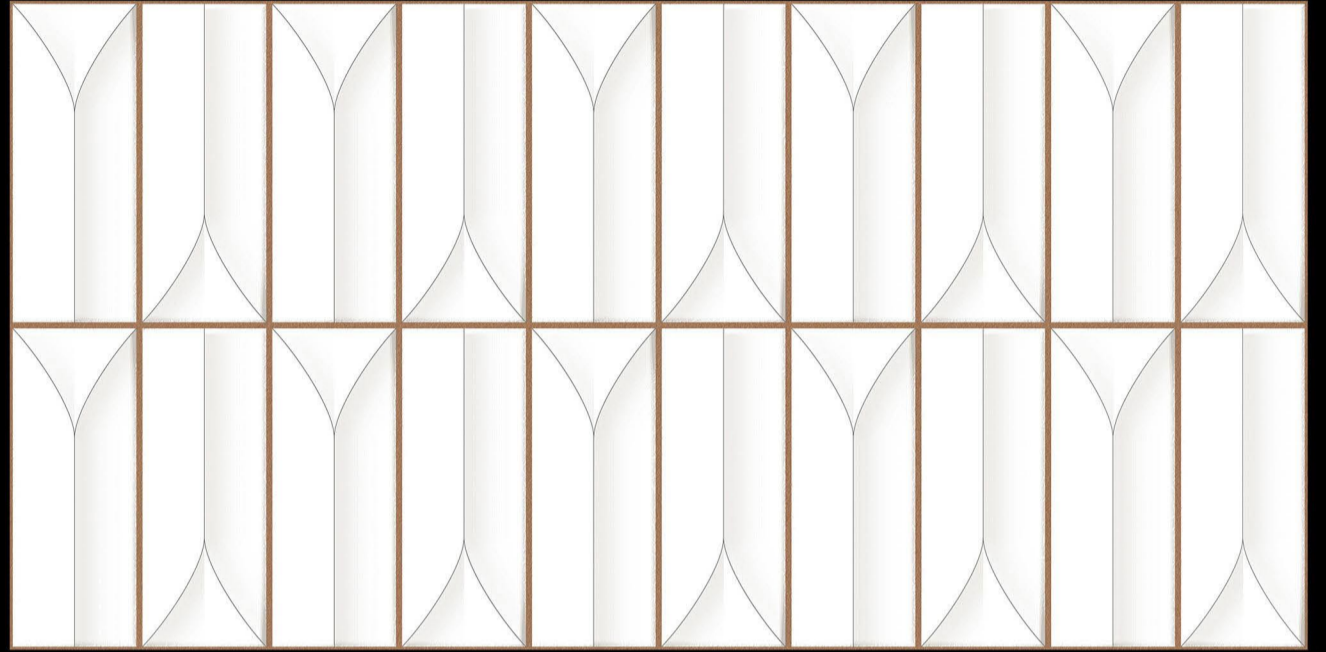

HL-1

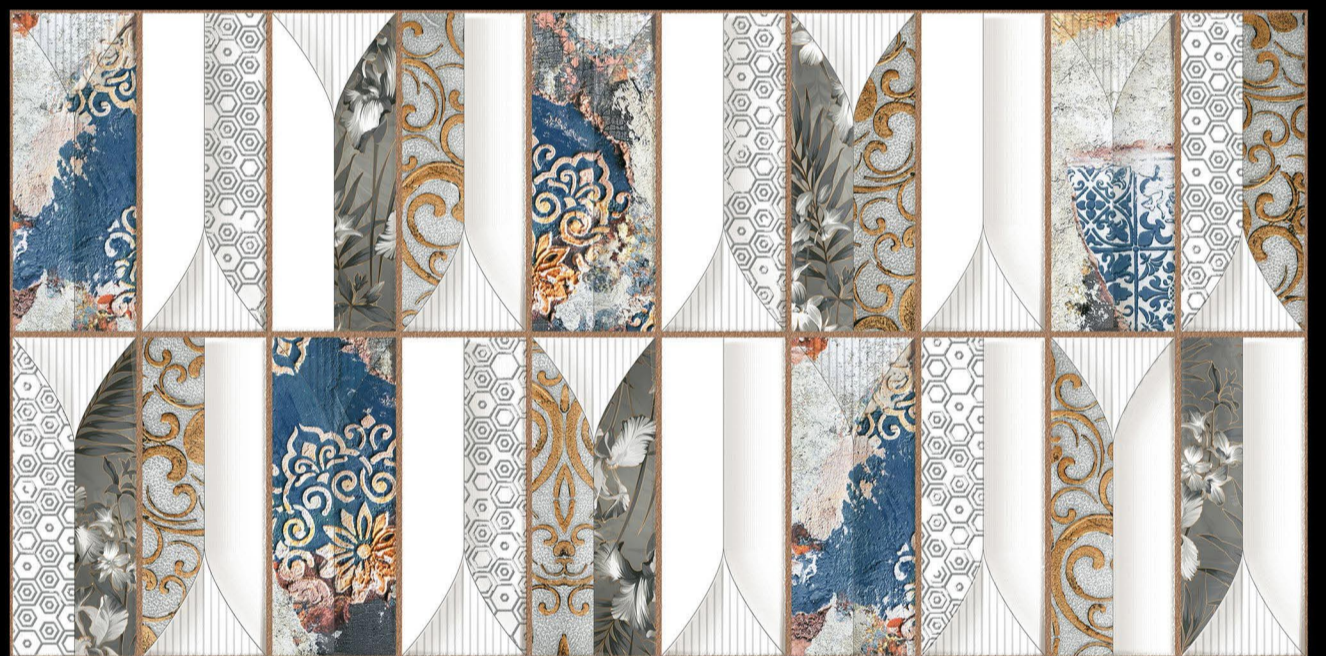

HL-2

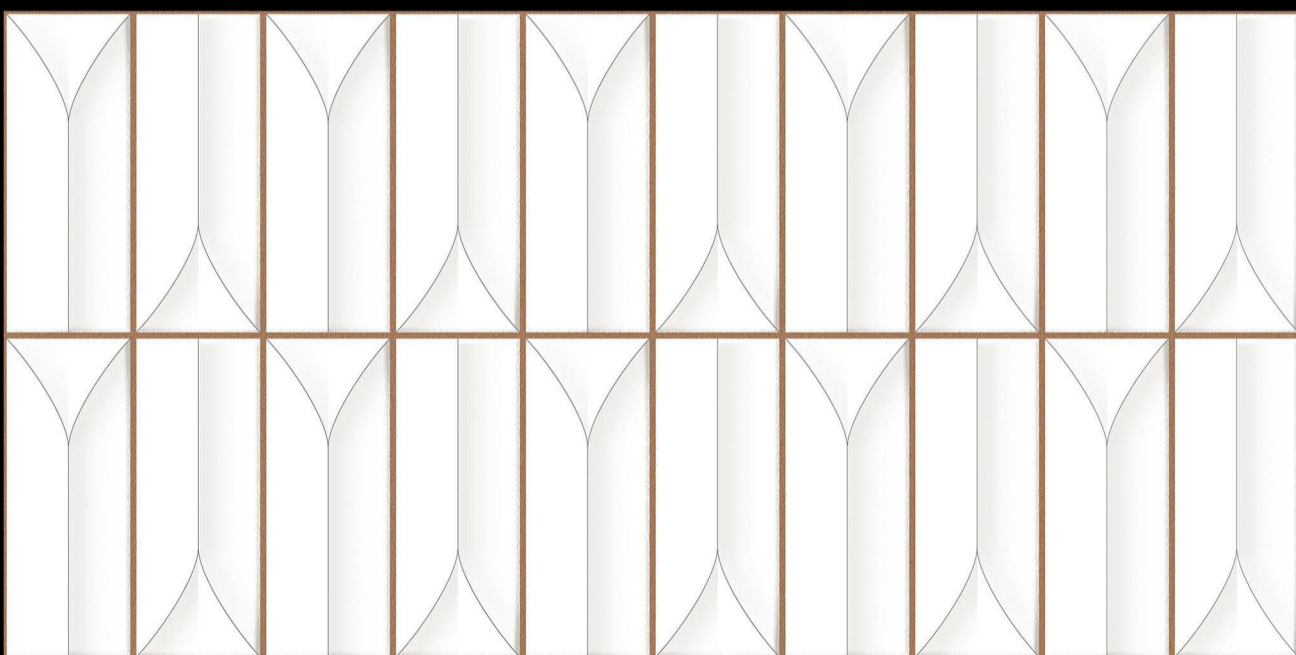

L

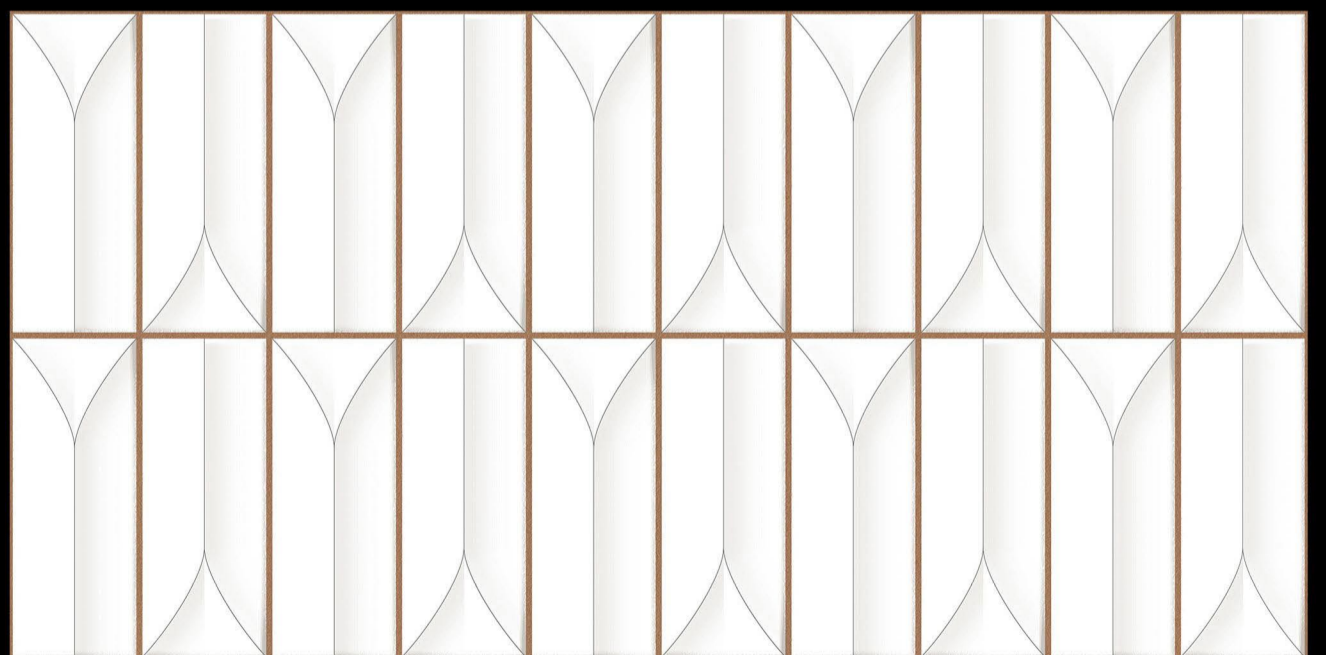

Glossy Finish

D.NO - SM-517



L

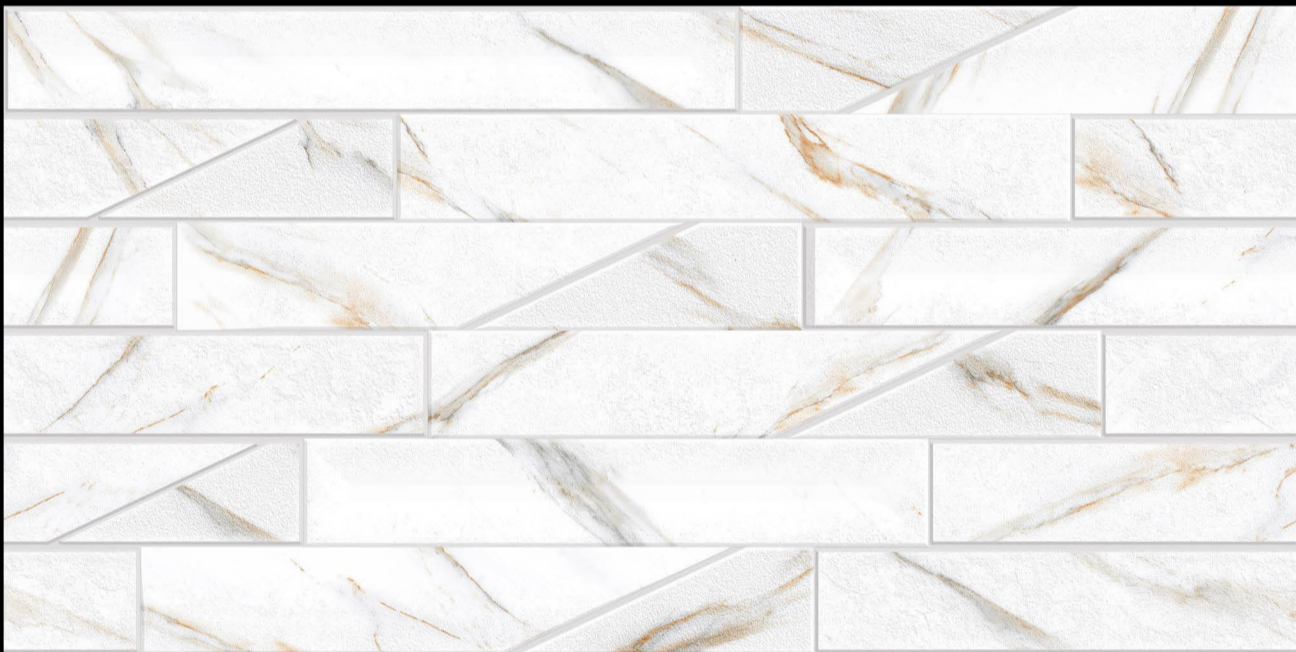

HL-1

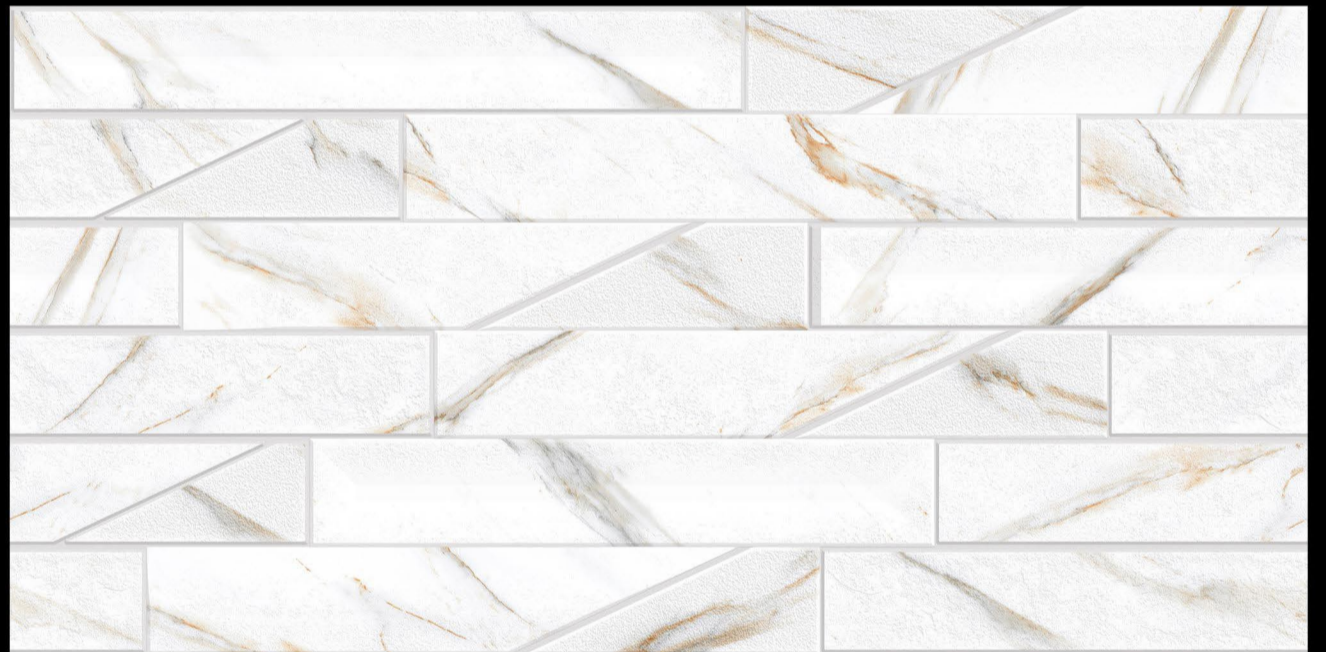

HL-1

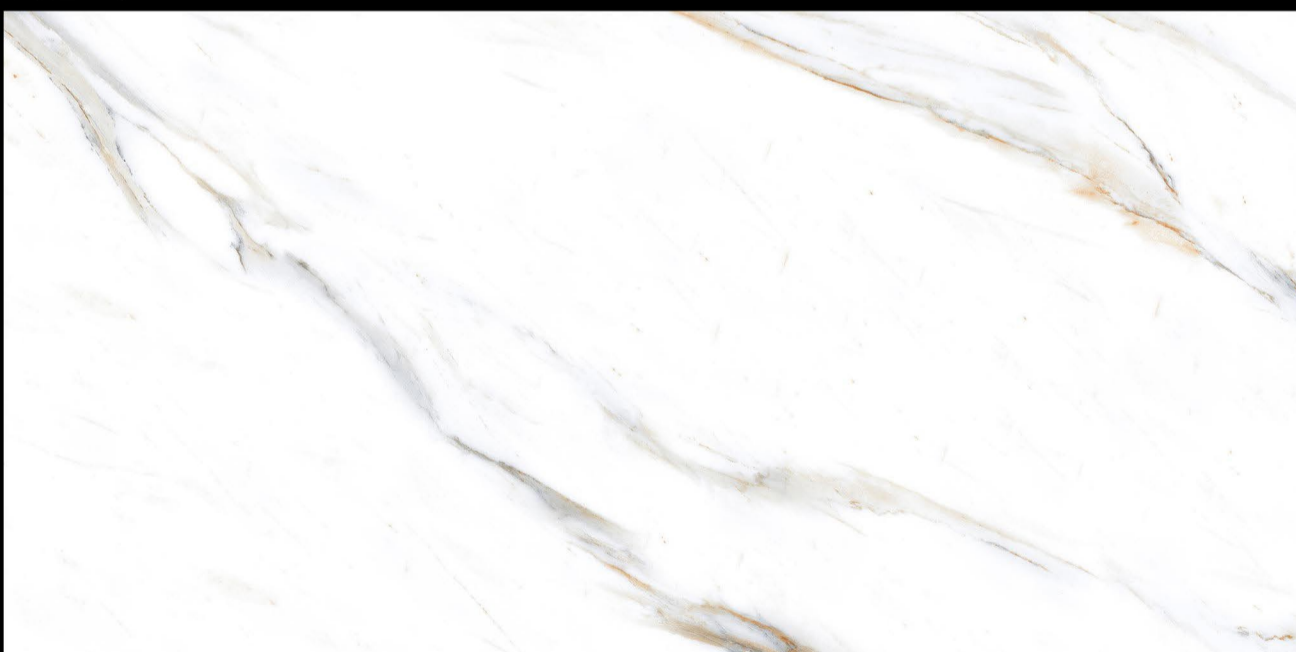

L



Glossy Finish

D.NO - SM-520

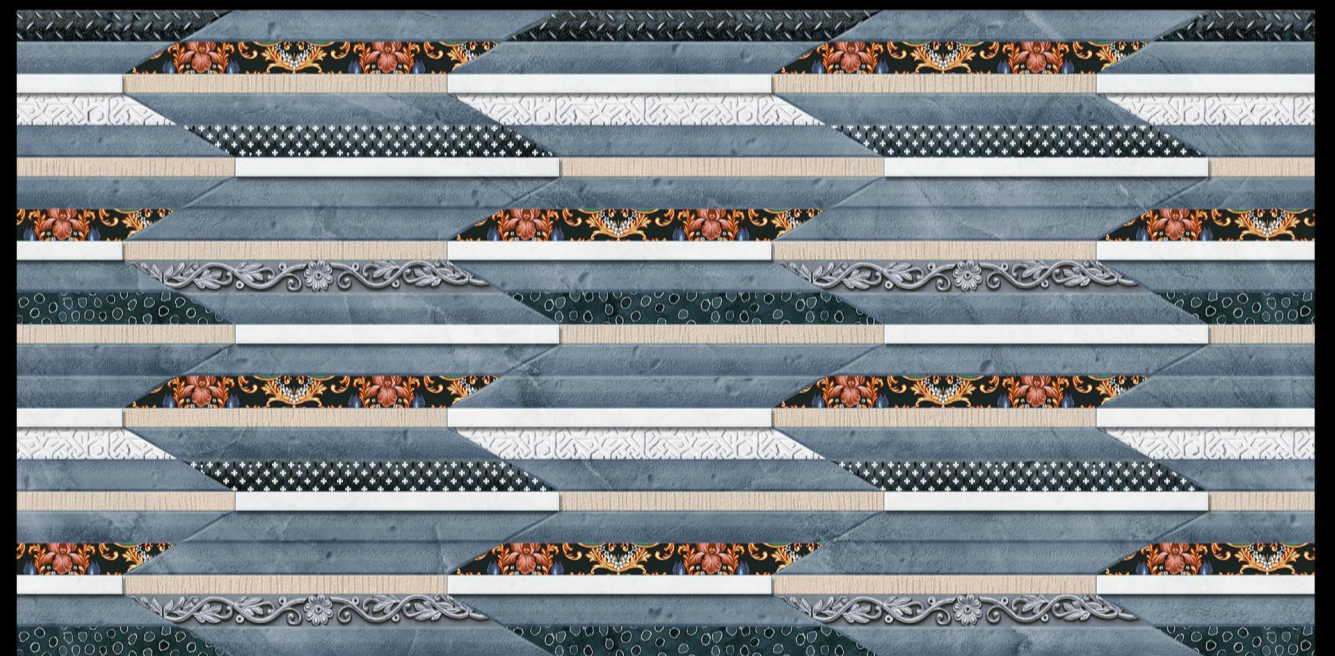
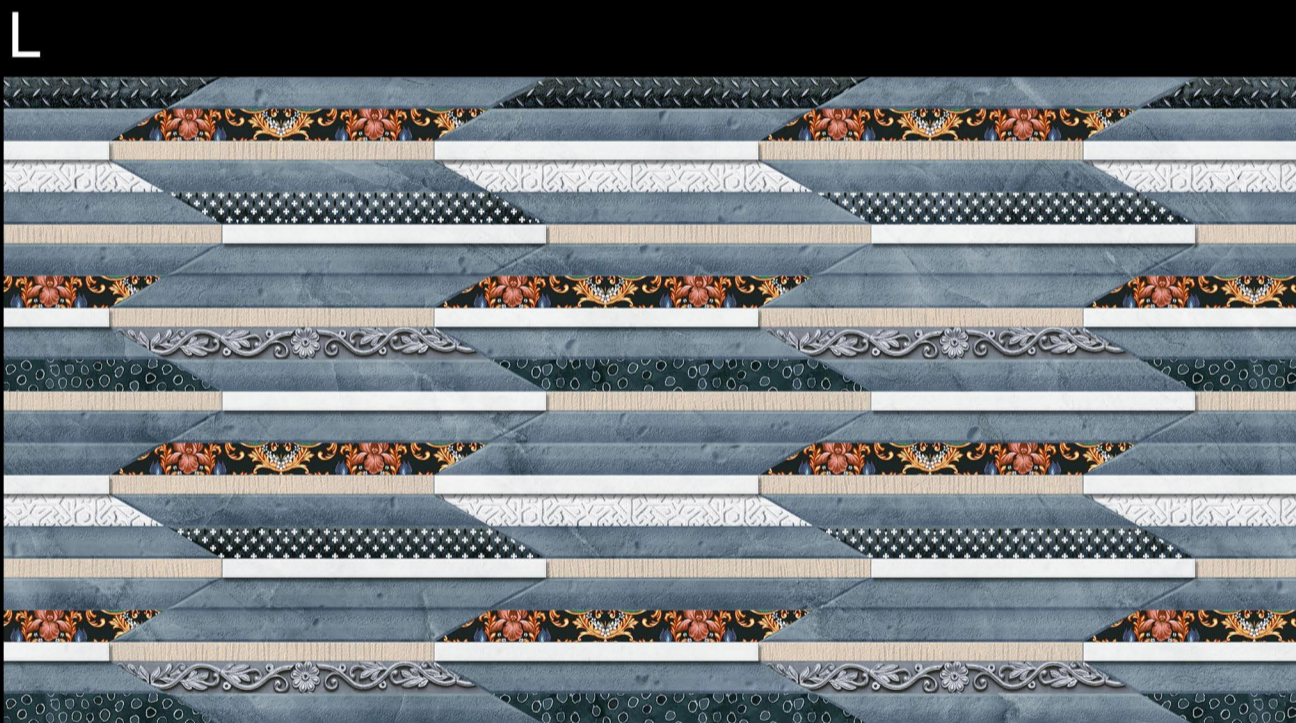

HL-2

HL-2



D



Glossy Finish

D.NO - SM-521



L



HL-2

HL-2



D



Glossy Finish

D.NO - SM-522

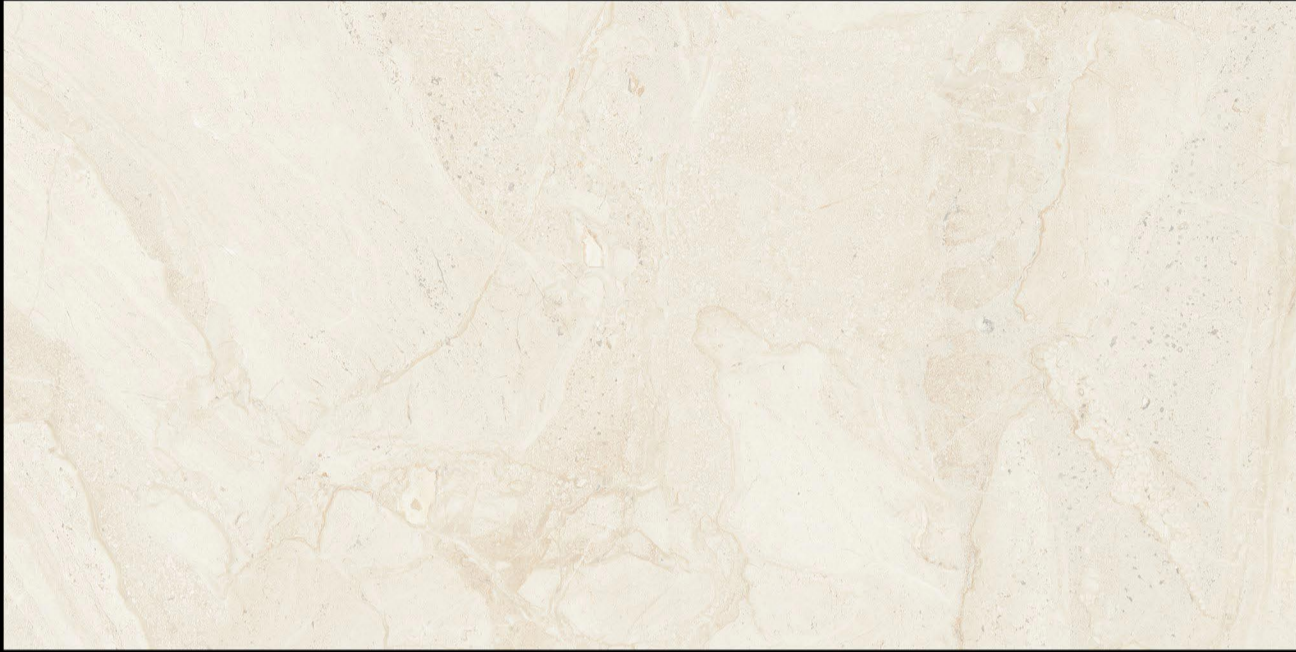

L



HL-1

HL-1

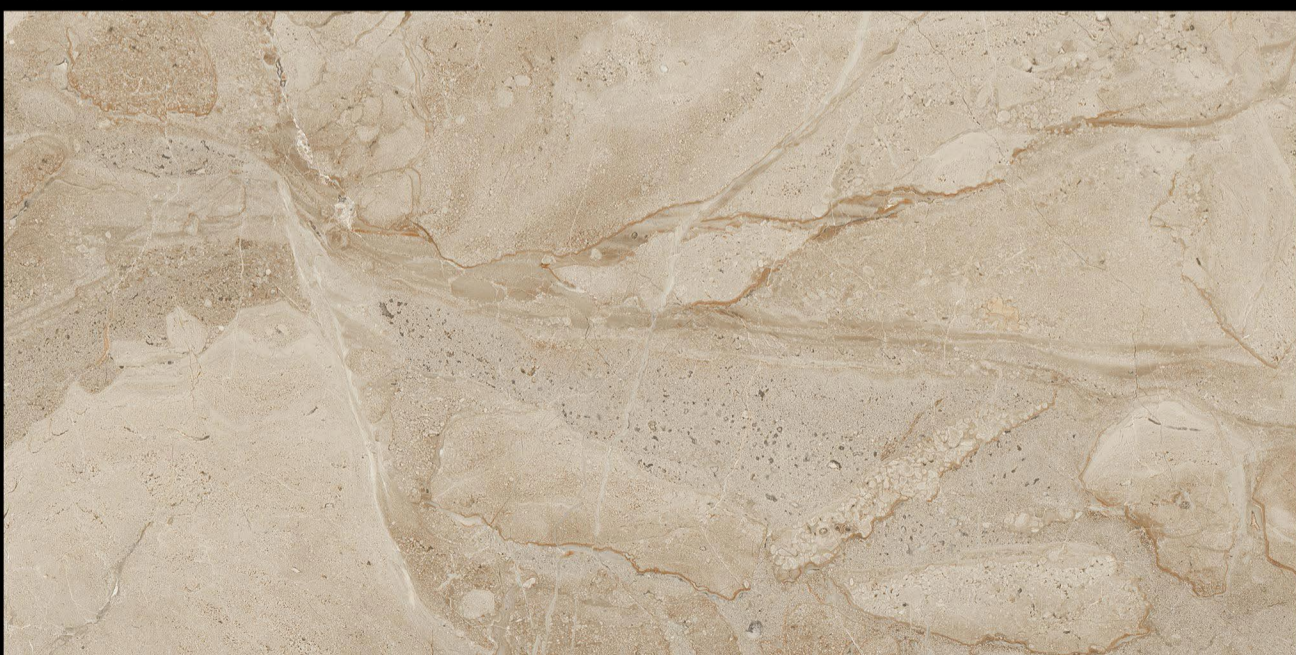

D



Glossy Finish

D.NO - SM-523

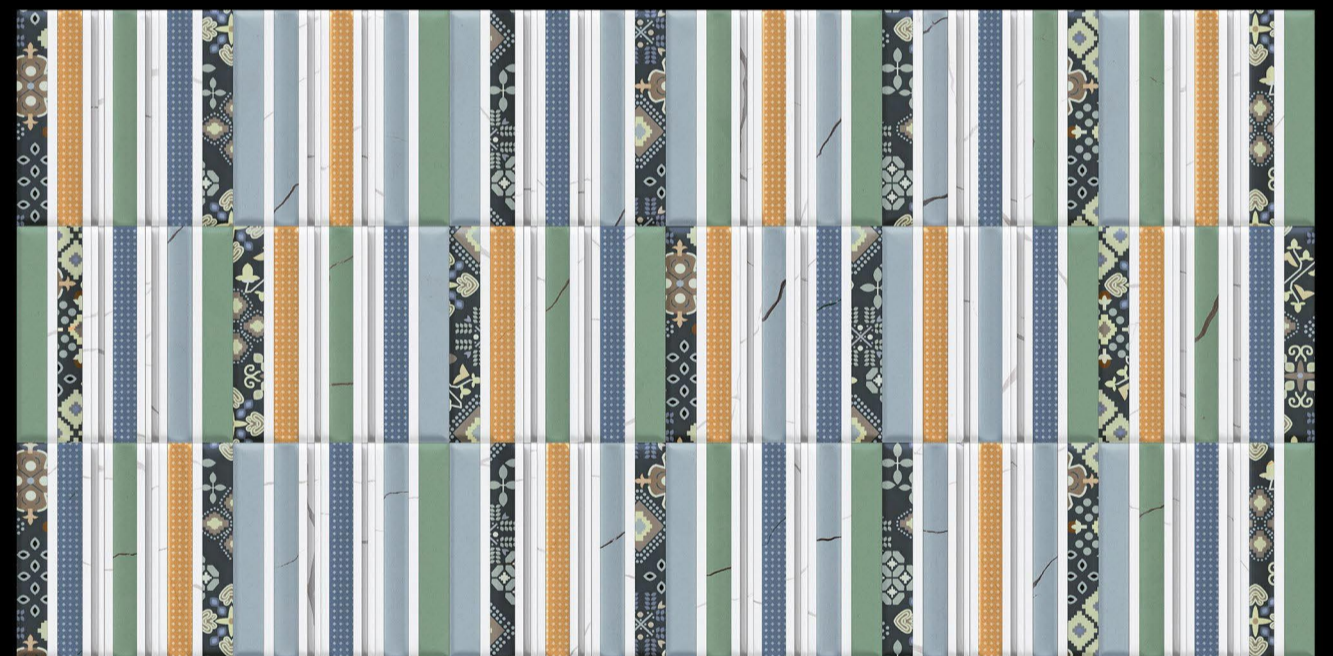
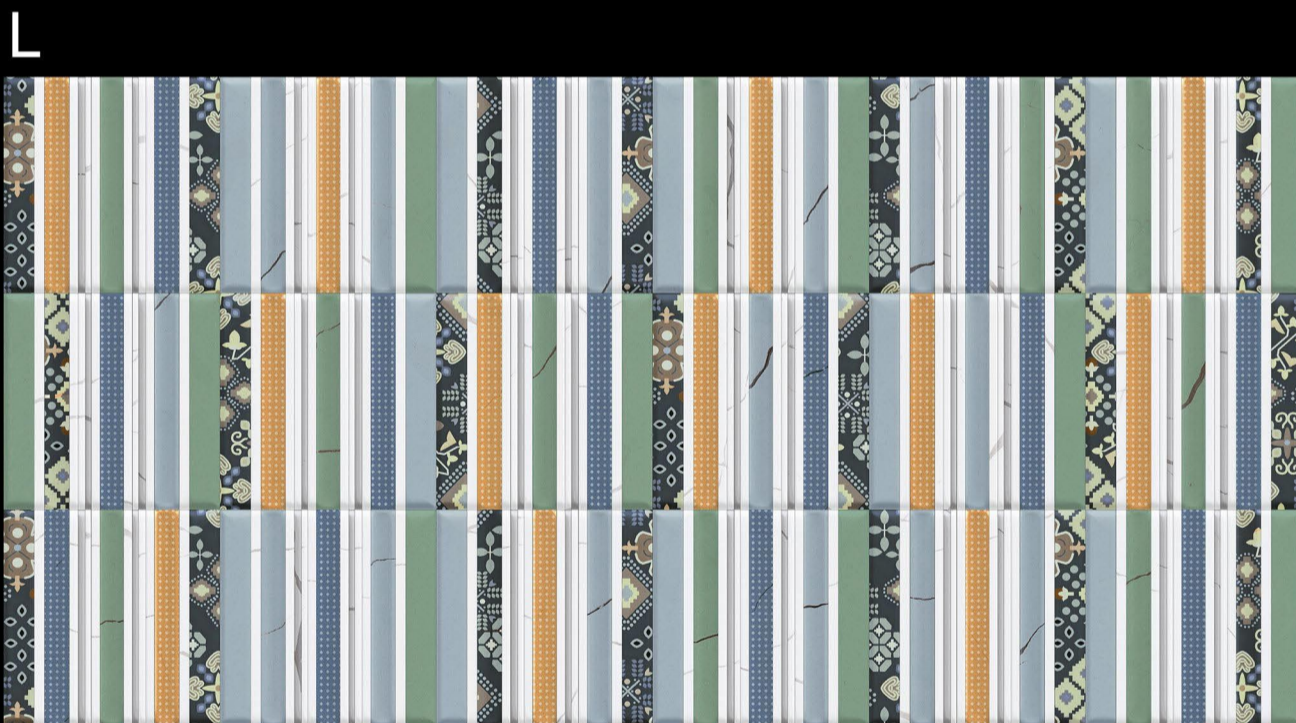

HL-1

HL-1



D



Glossy Finish

D.NO - SM-524

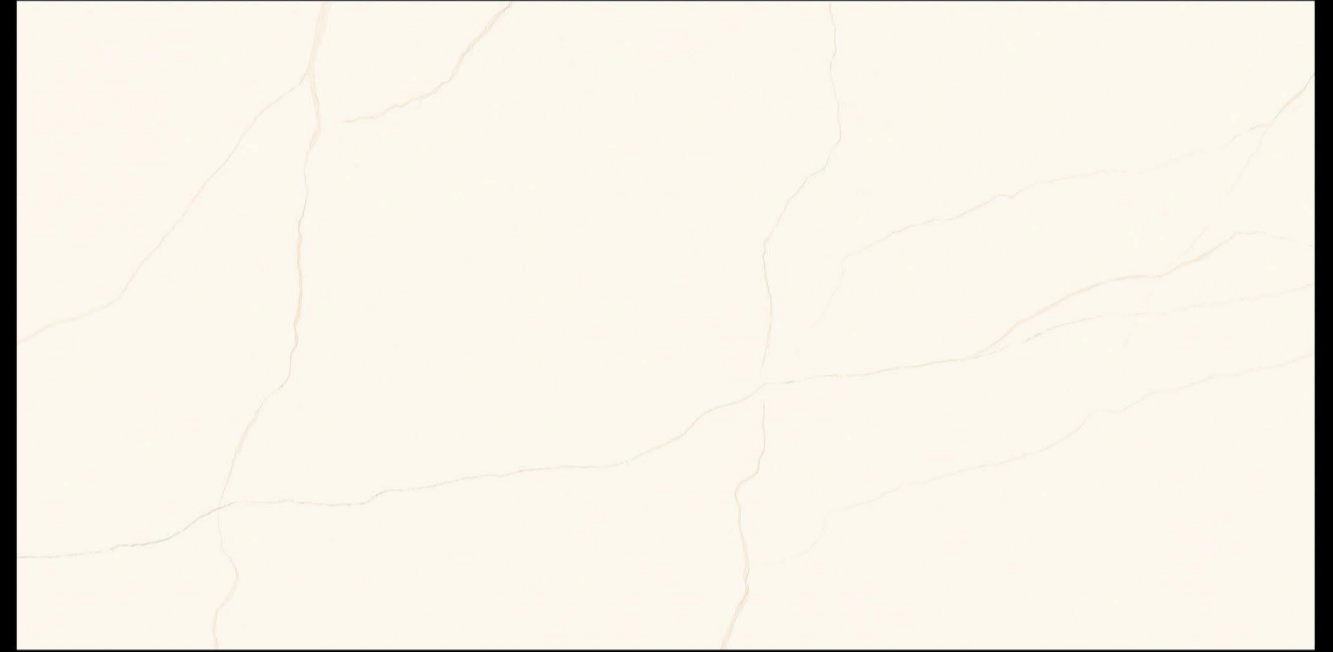

L

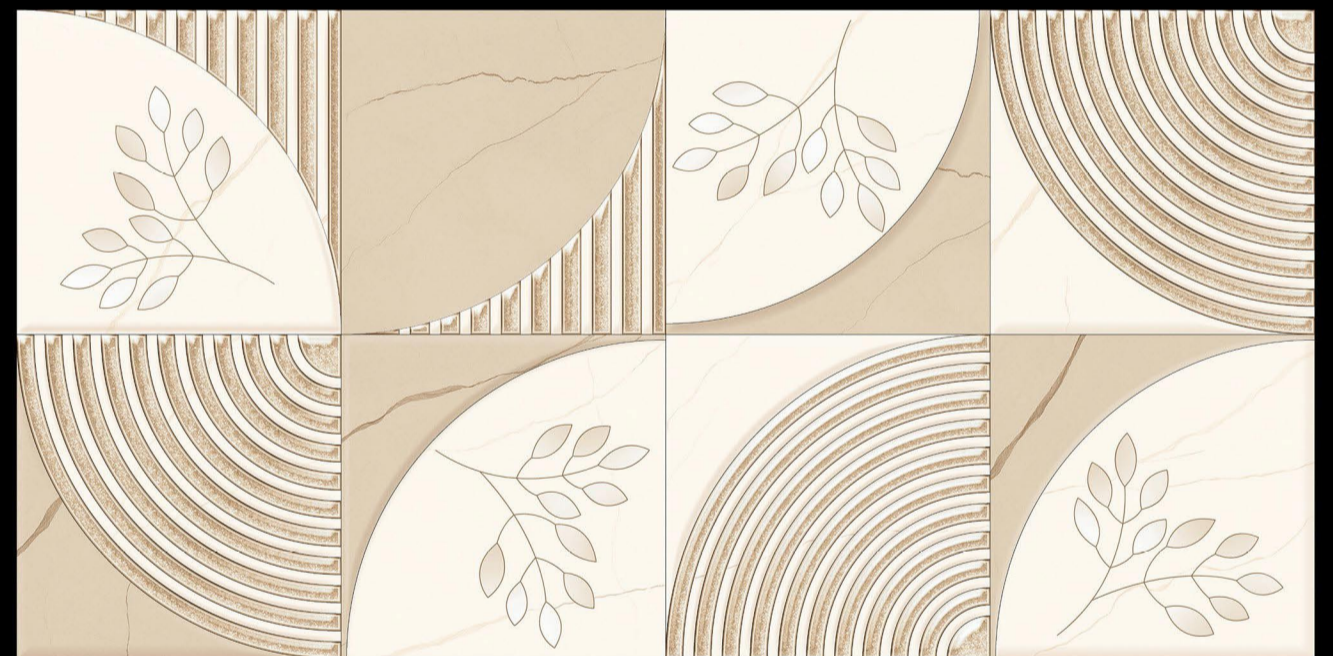

HL-1

HL-2



D



Glossy Finish

D.NO - SM-525



L

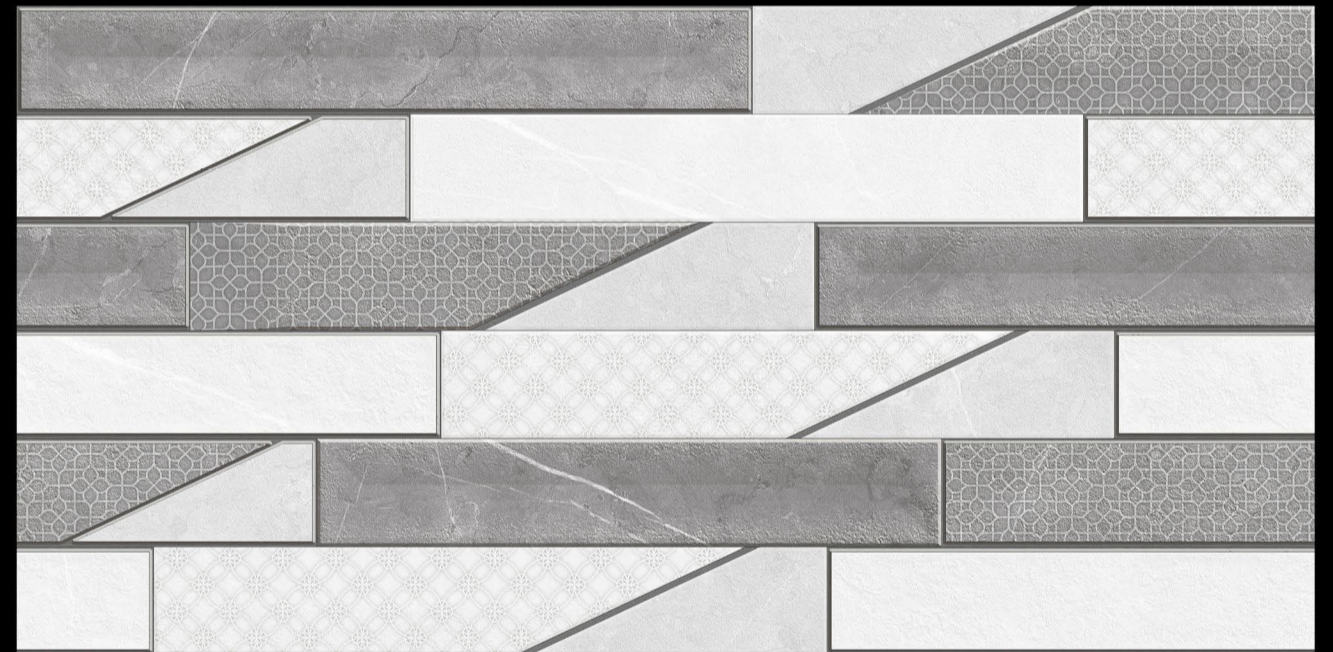

HL-1

HL-2



D



Glossy Finish

D.NO - SM-526



L



HL-1

HL-1

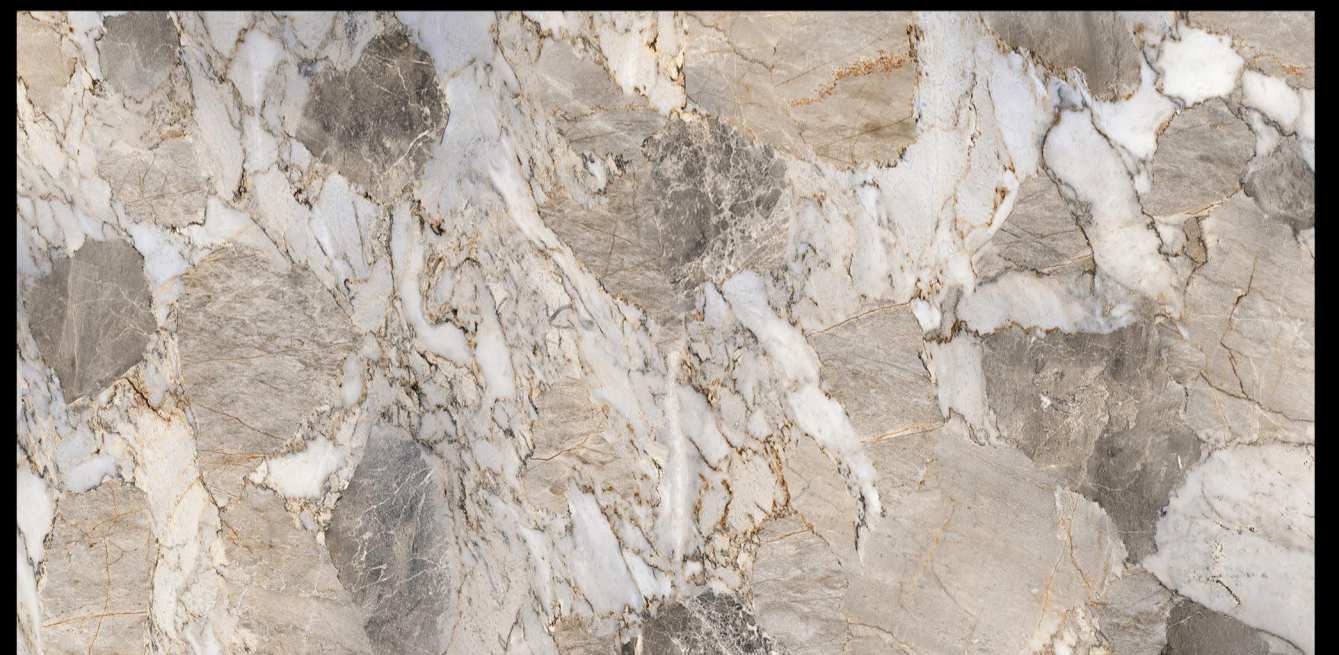

D



Glossy Finish

D.NO - SM-527



L

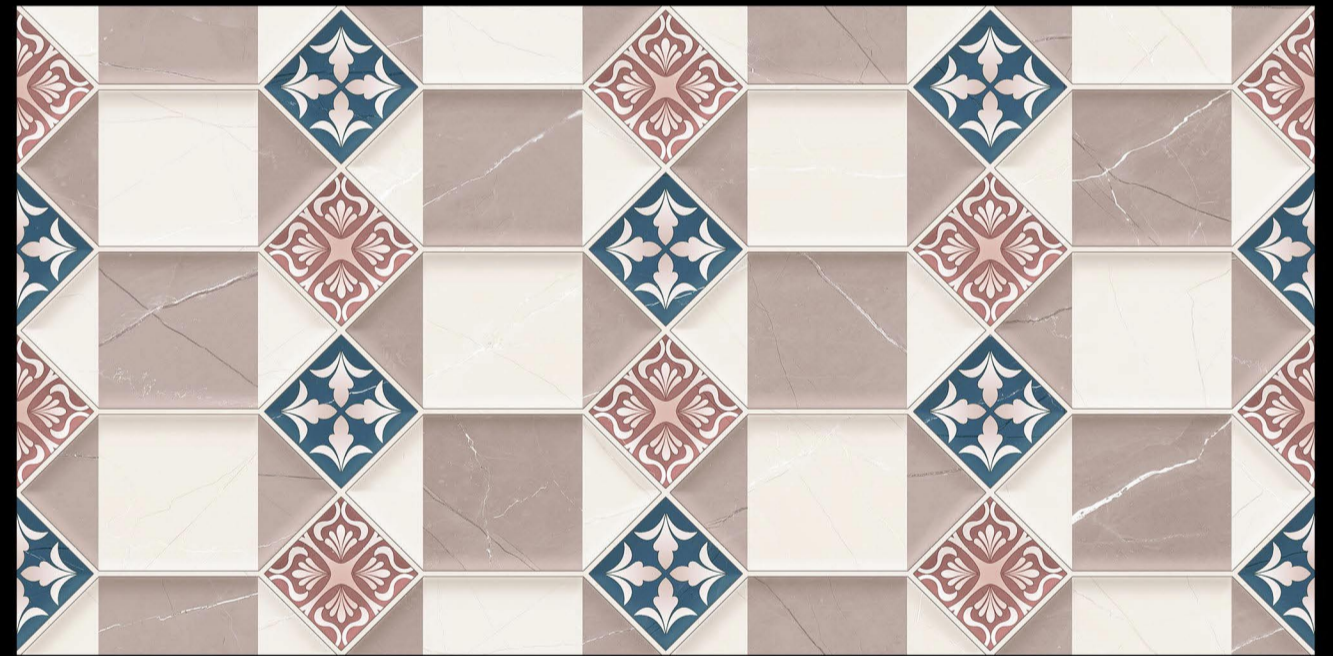

HL-1

HL-1

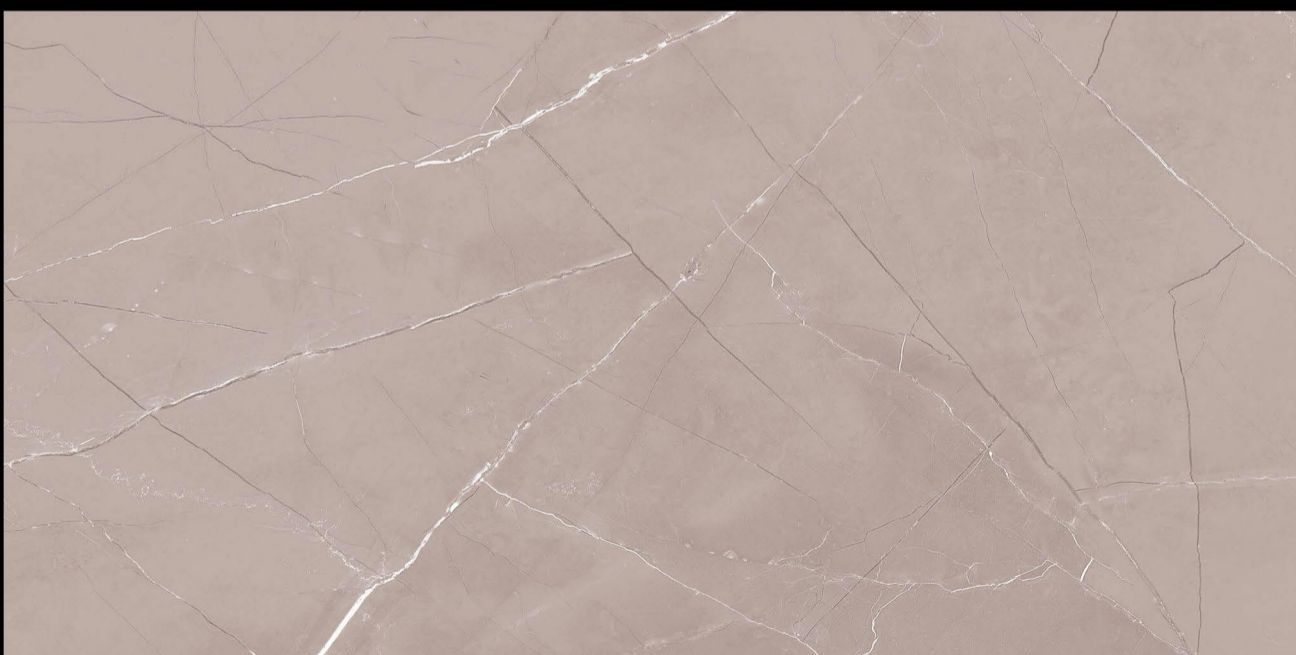

D



Glossy Finish

D.NO - SM-528



L

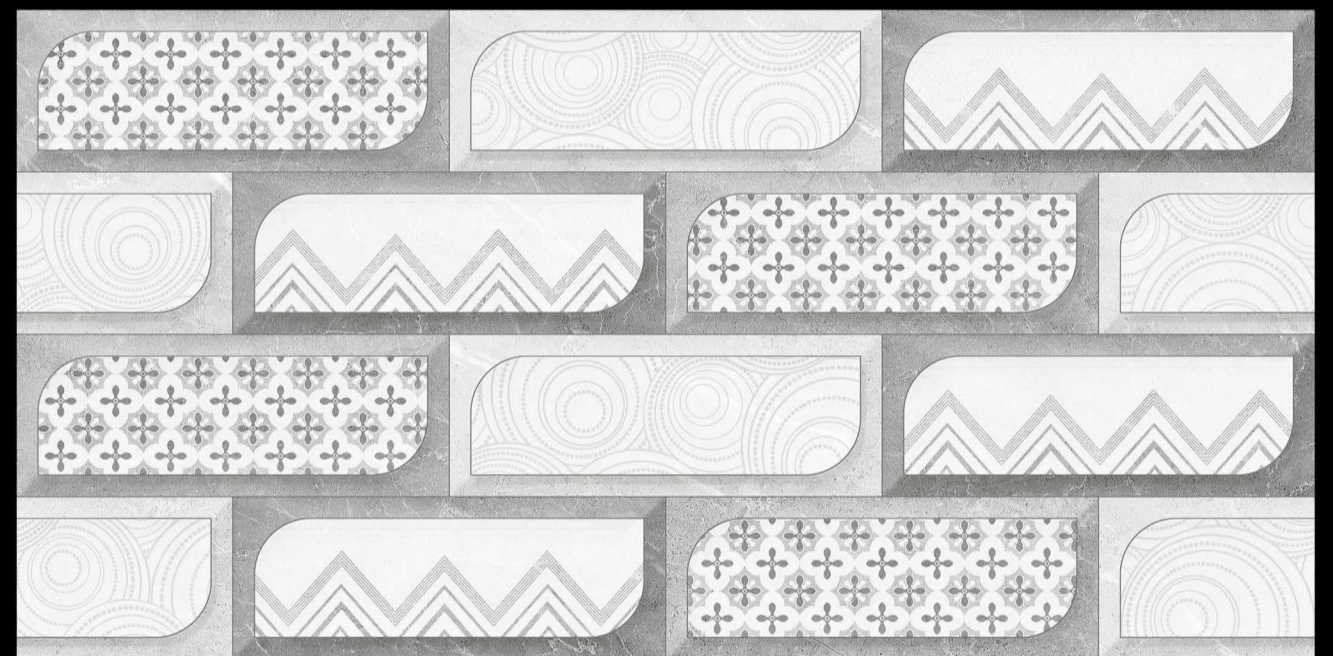

HL-1

HL-2



D



Glossy Finish

D.NO - SM-529

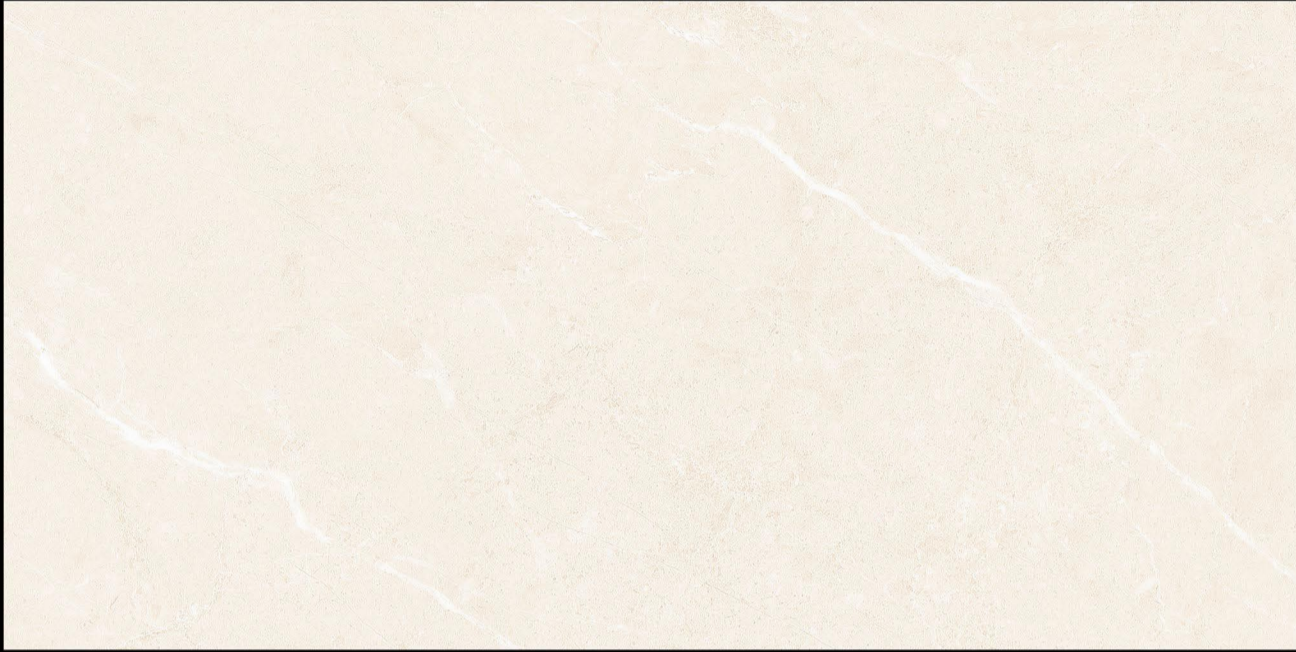

L

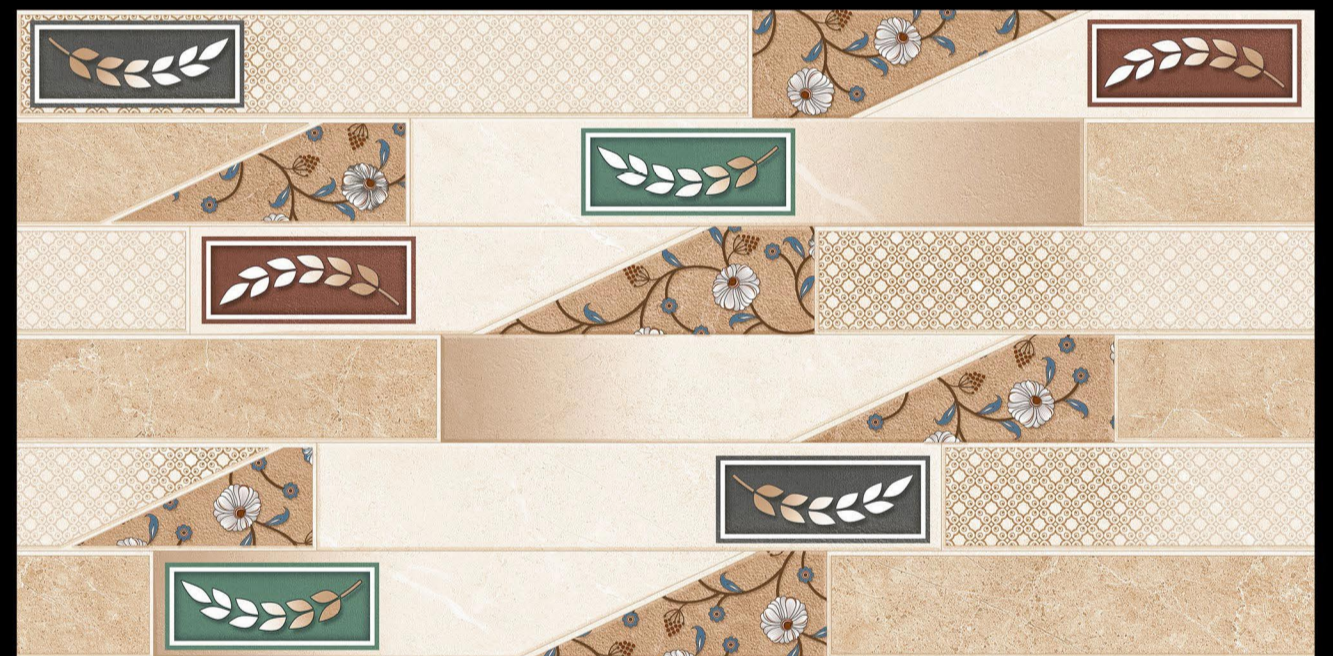
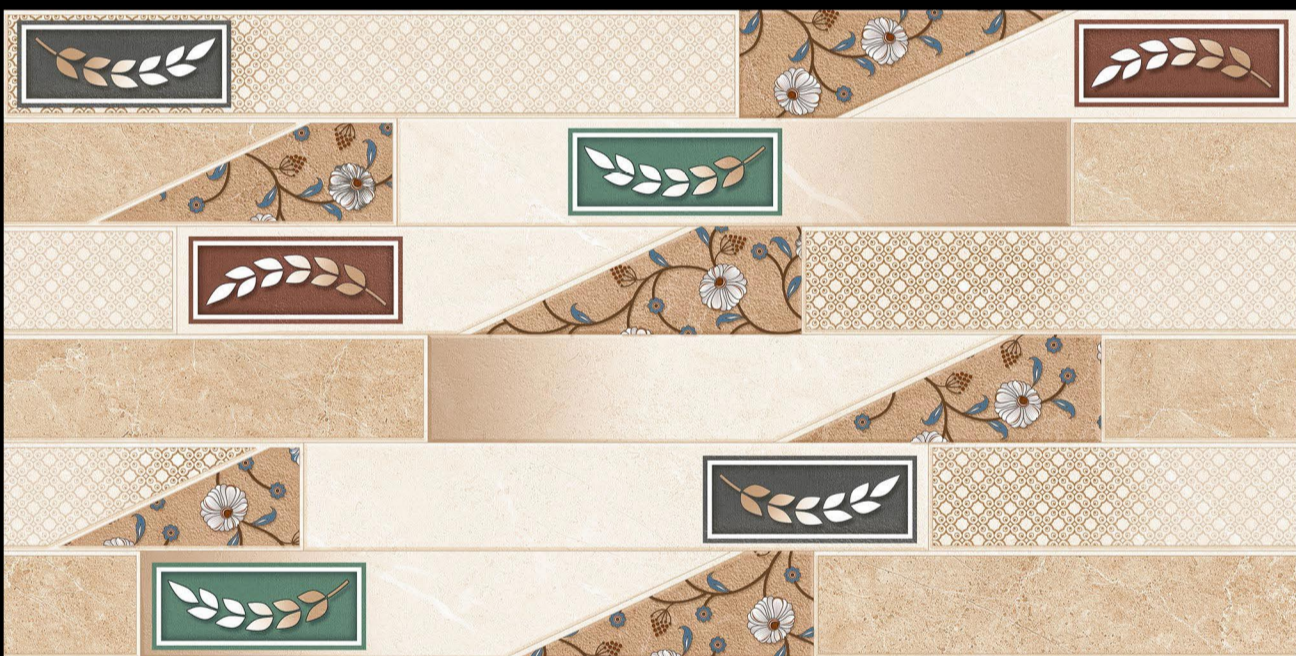

HL-1

HL-1

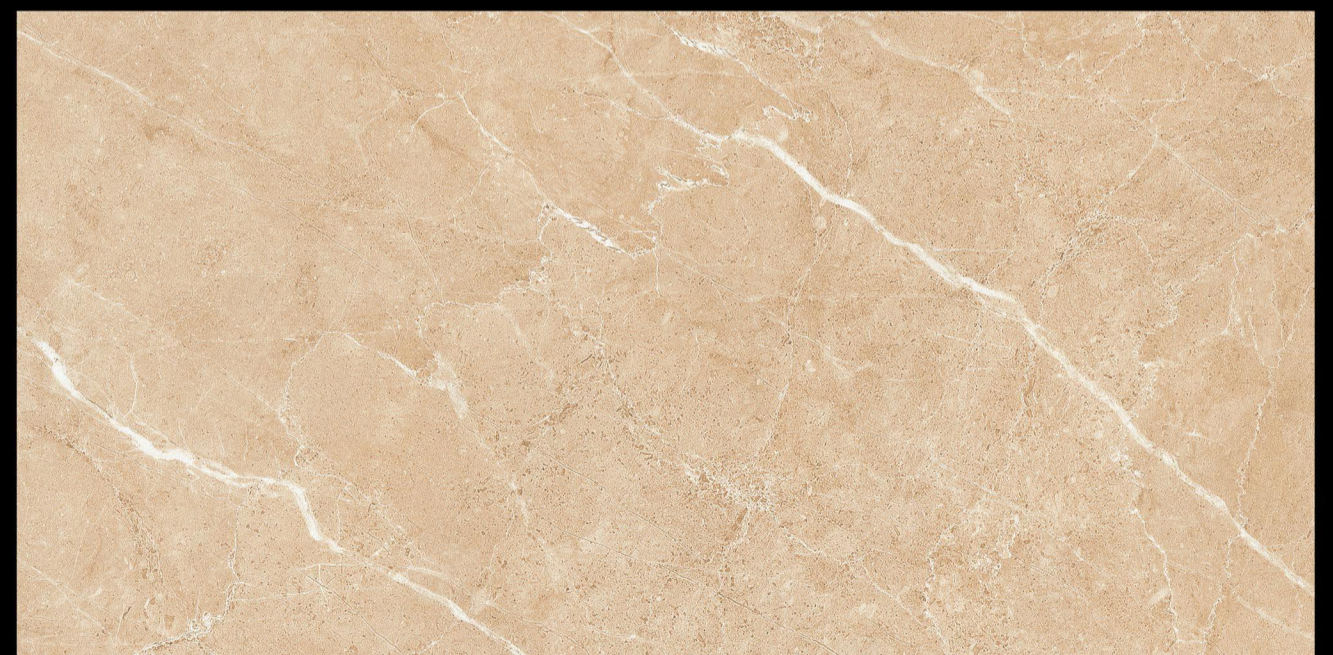

D



Glossy Finish

D.NO - SM-530



L



HL-1

HL-1



D



Glossy Finish

D.NO - SM-531

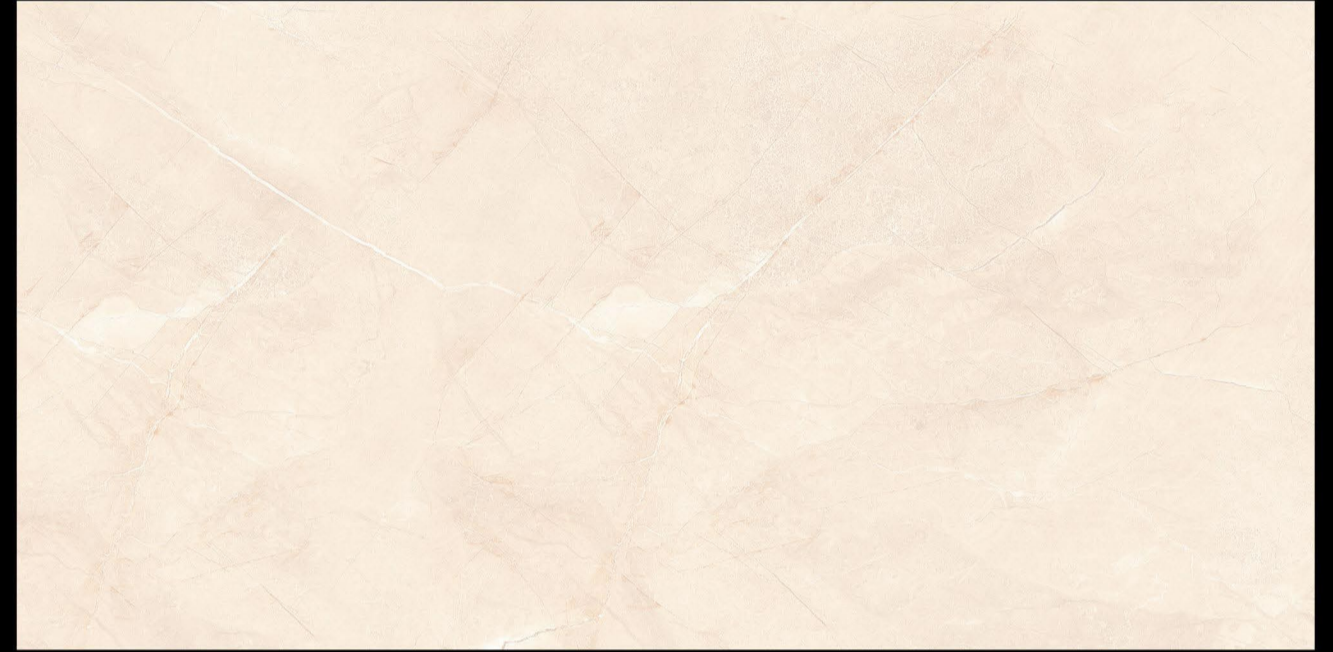

L



HL-1

HL-2



D



Glossy Finish

D.NO - SM-534



L

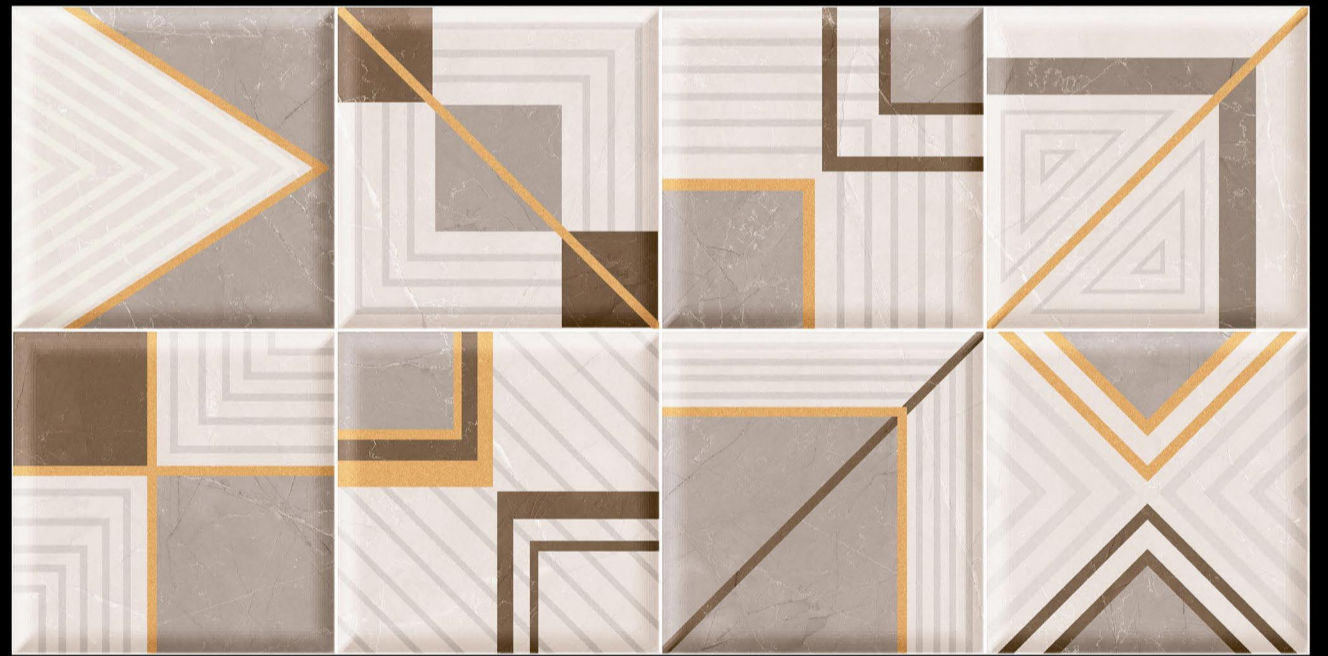
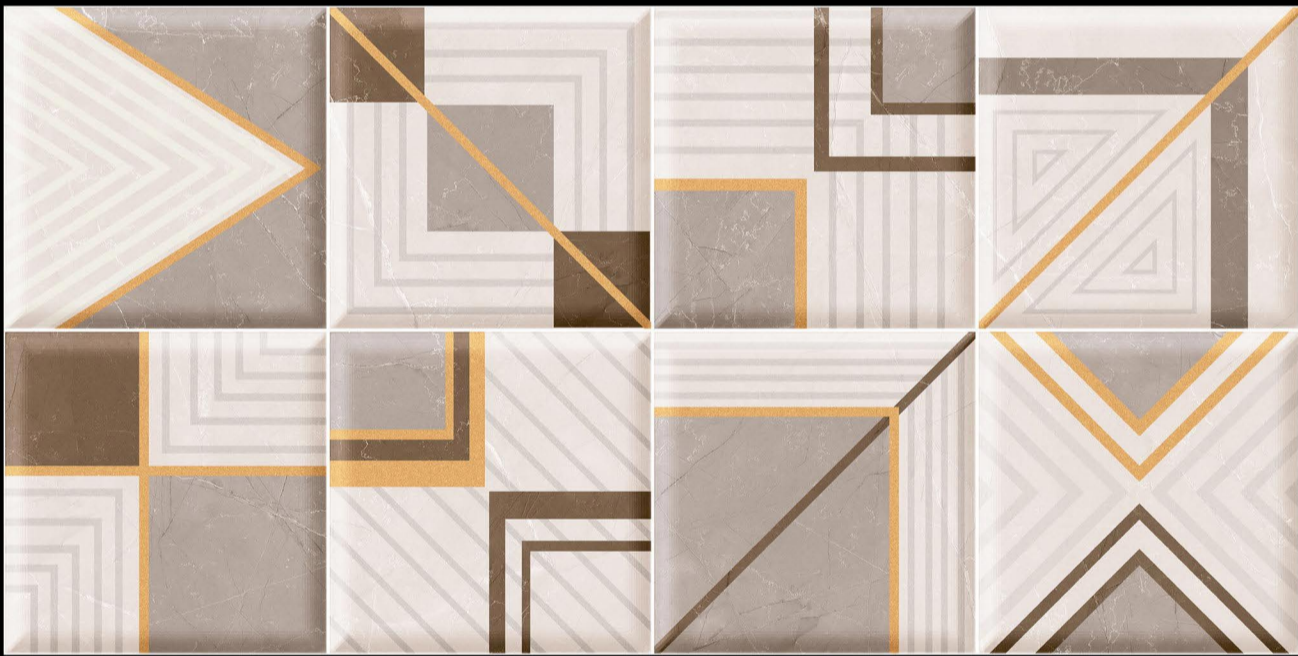

HL-1

HL-1



D



Glossy Finish

D.NO - SM-535



L

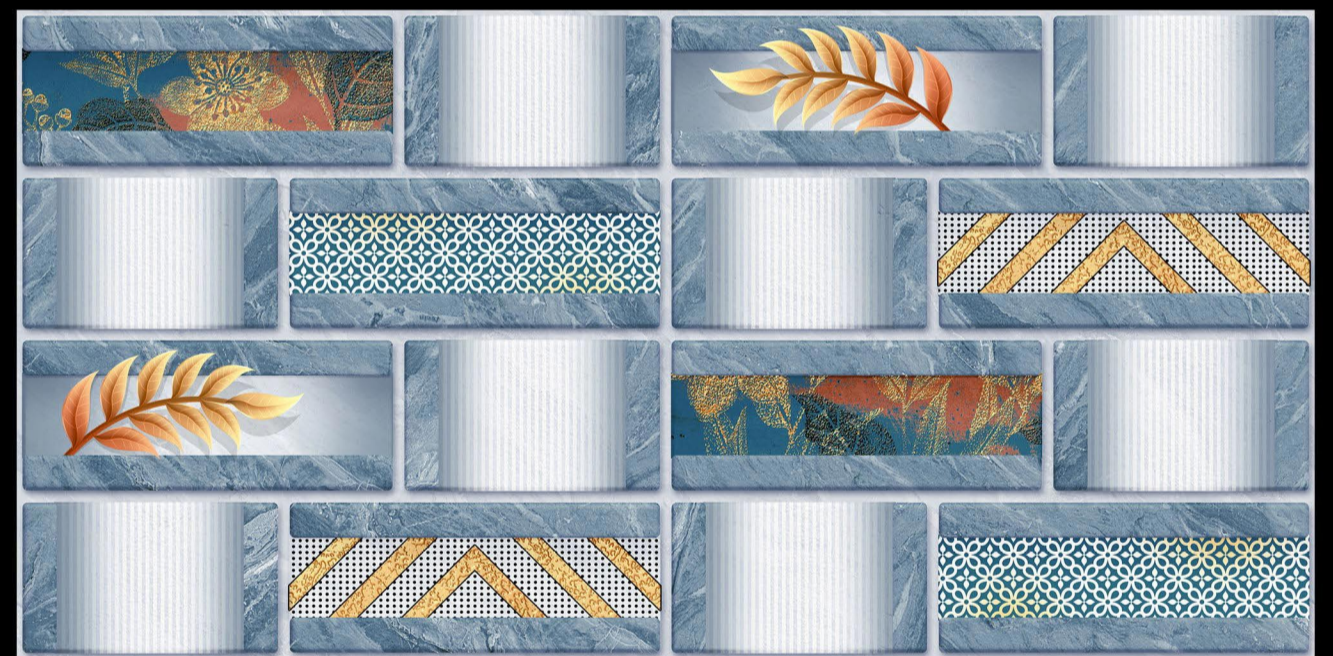
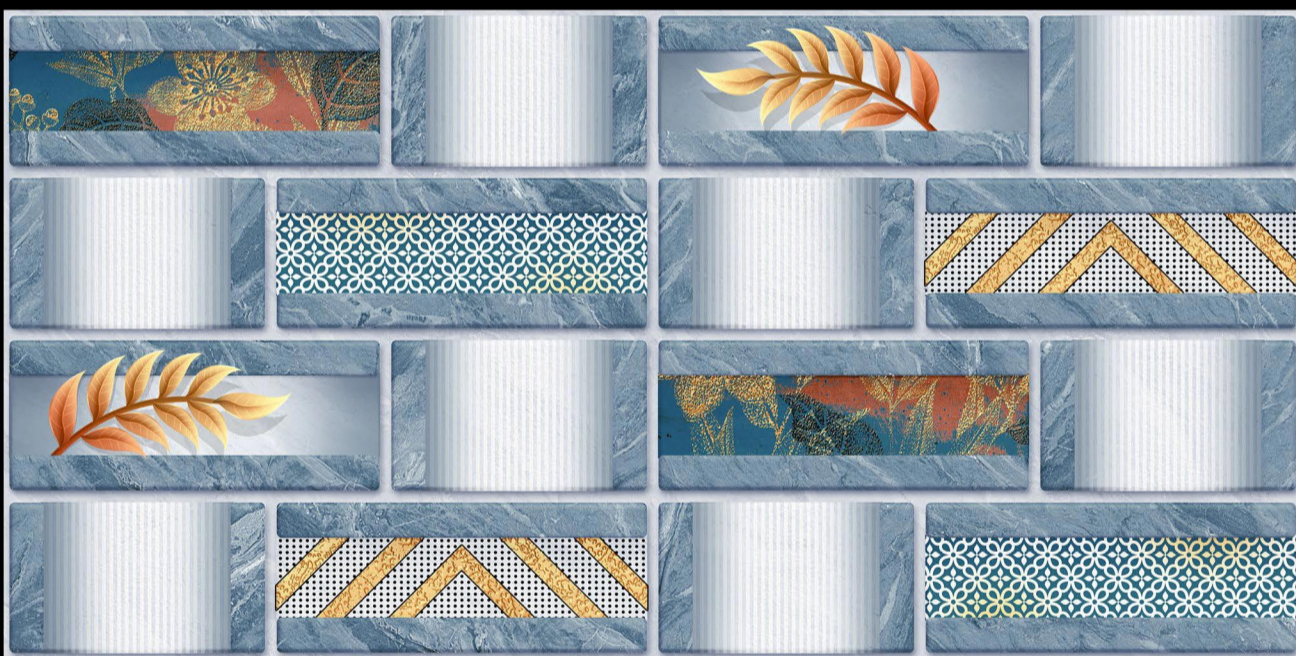

HL-1

HL-1

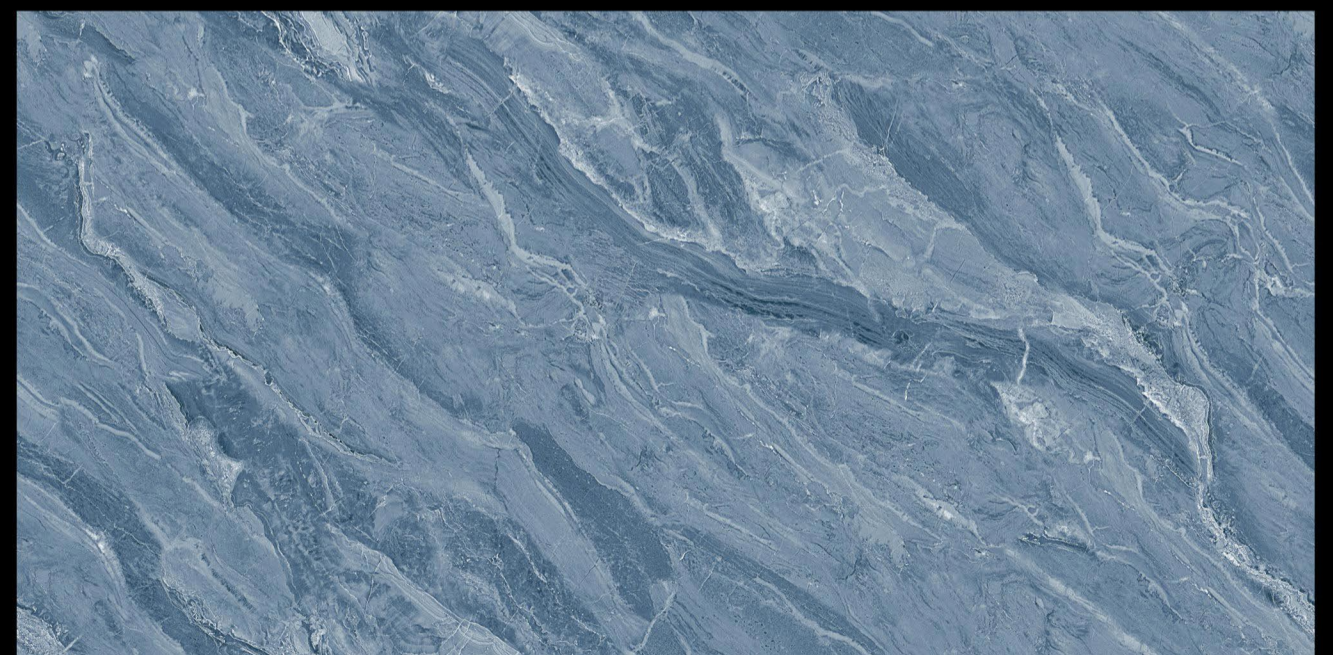
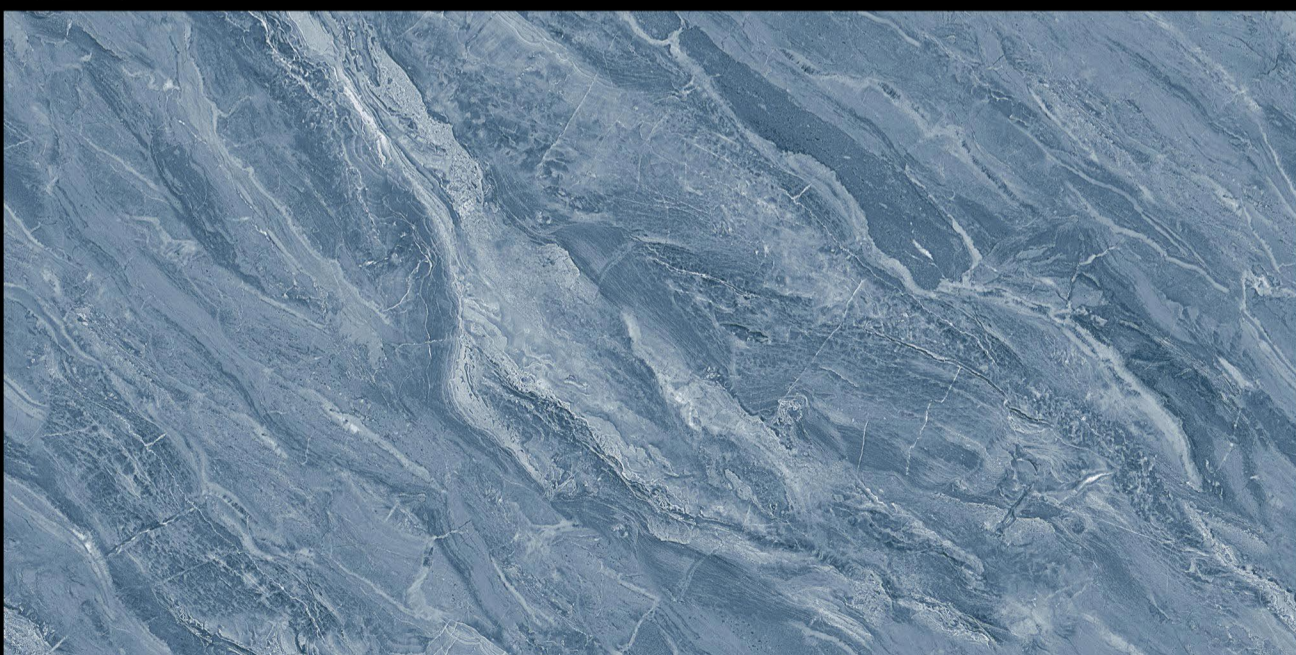

D



Glossy Finish

D.NO - SM-536



L

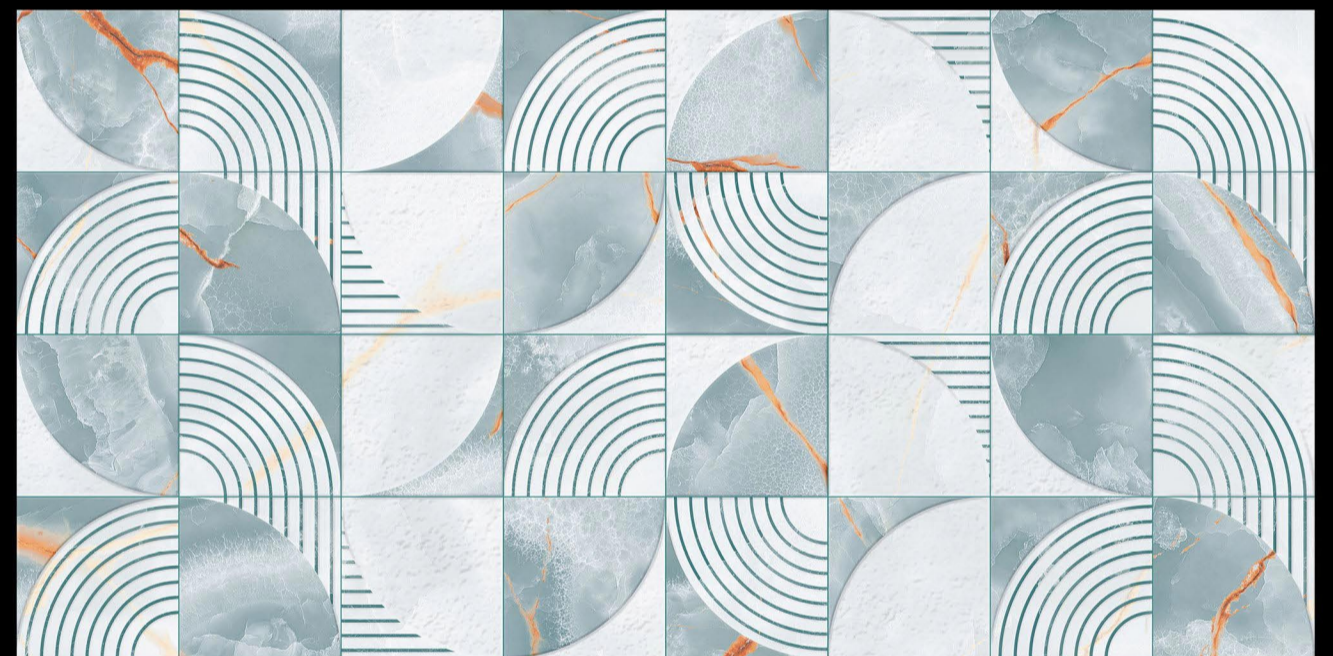
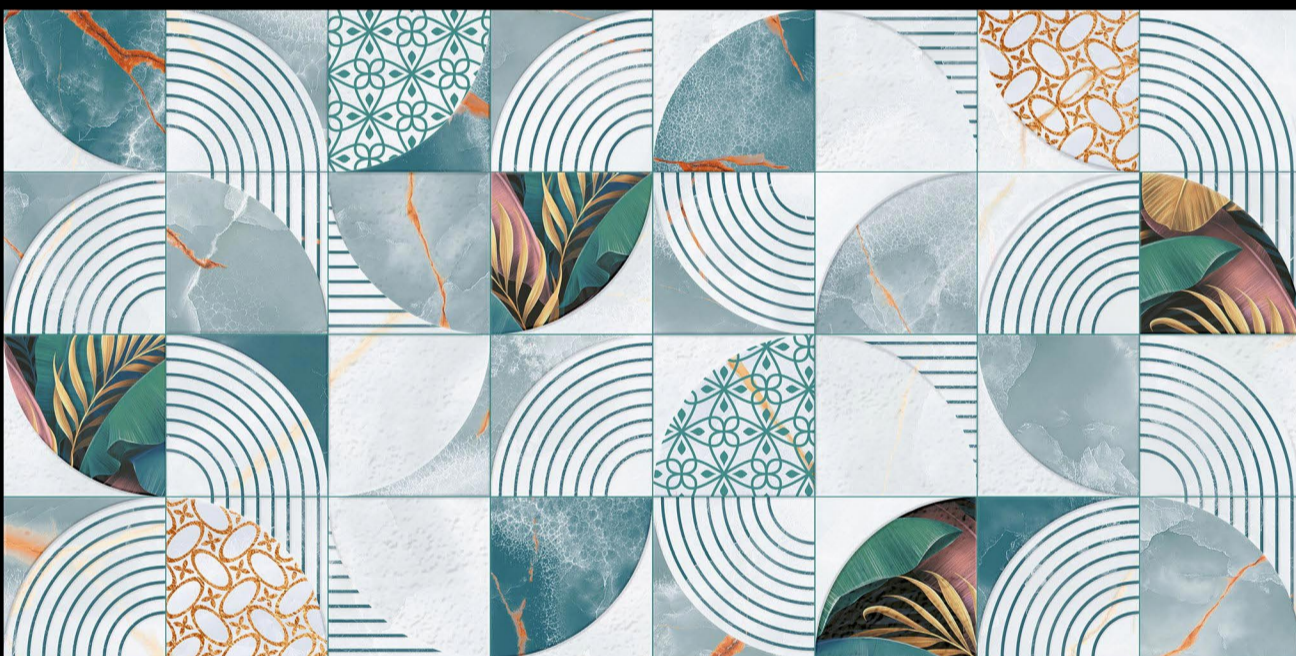

HL-1

HL-2



D



Glossy Finish

D.NO - SM-538



L

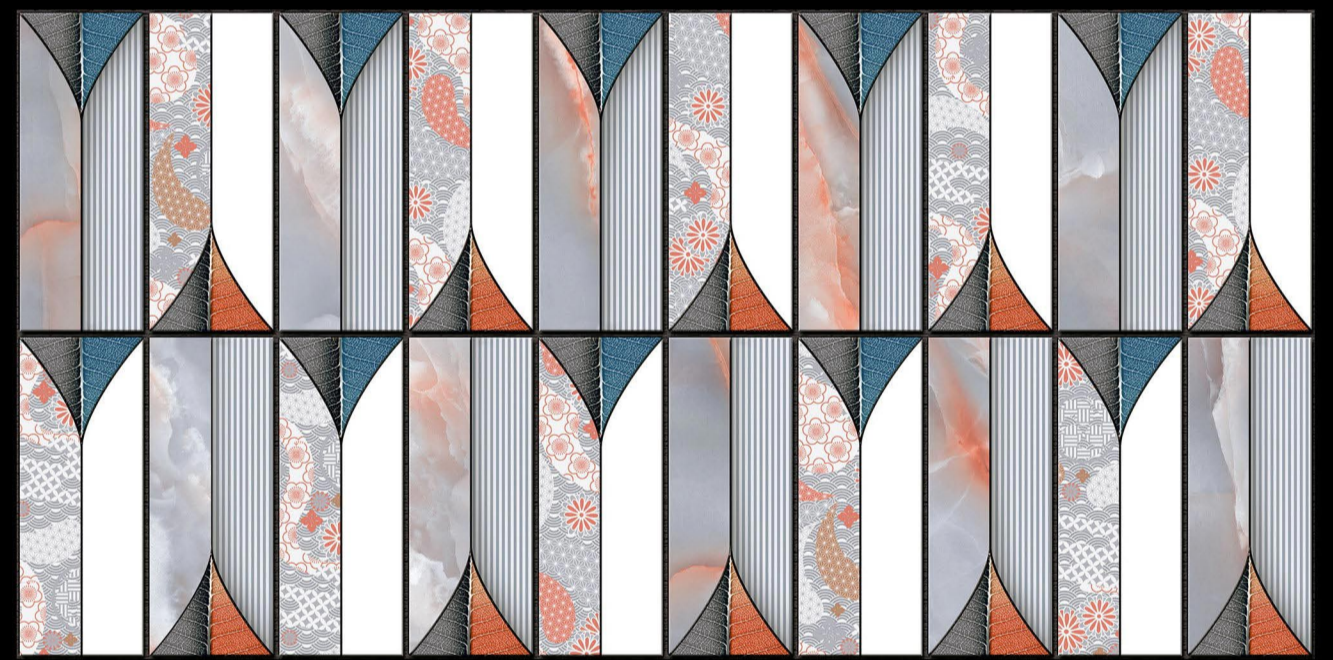

HL-1

HL-2



D



Glossy Finish

D.NO - SM-539



L



HL-2

HL-3

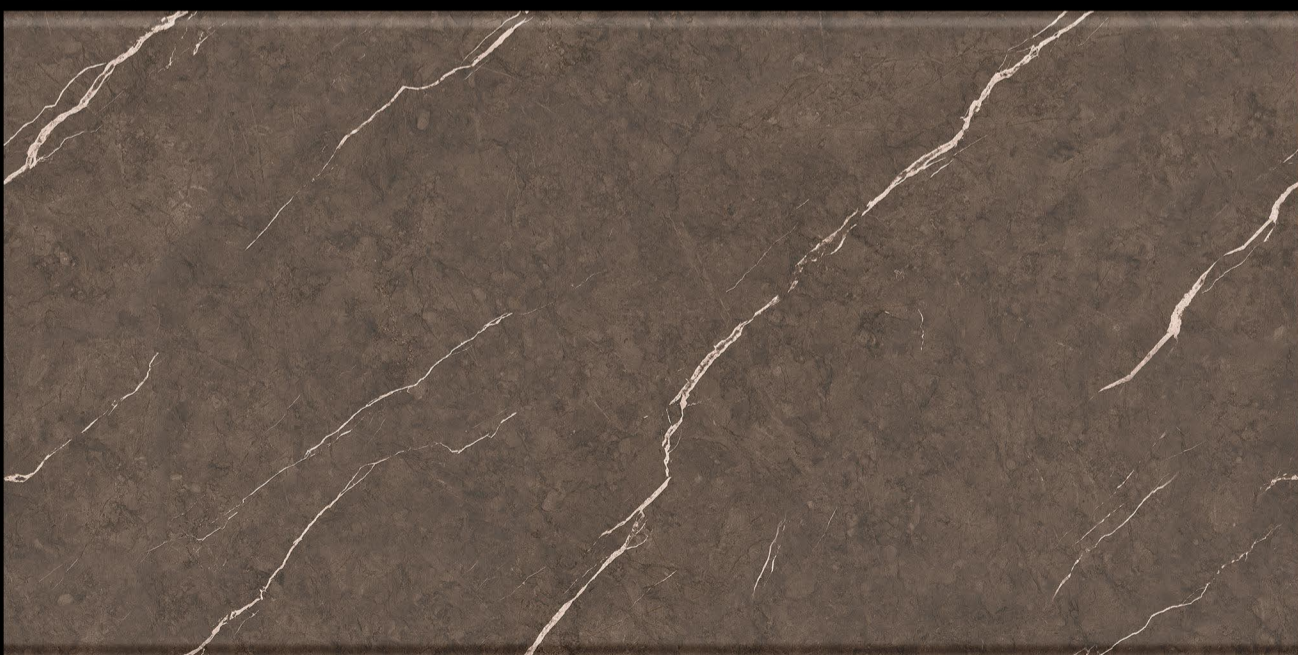

D



Glossy Finish

D.NO - SM-540



L

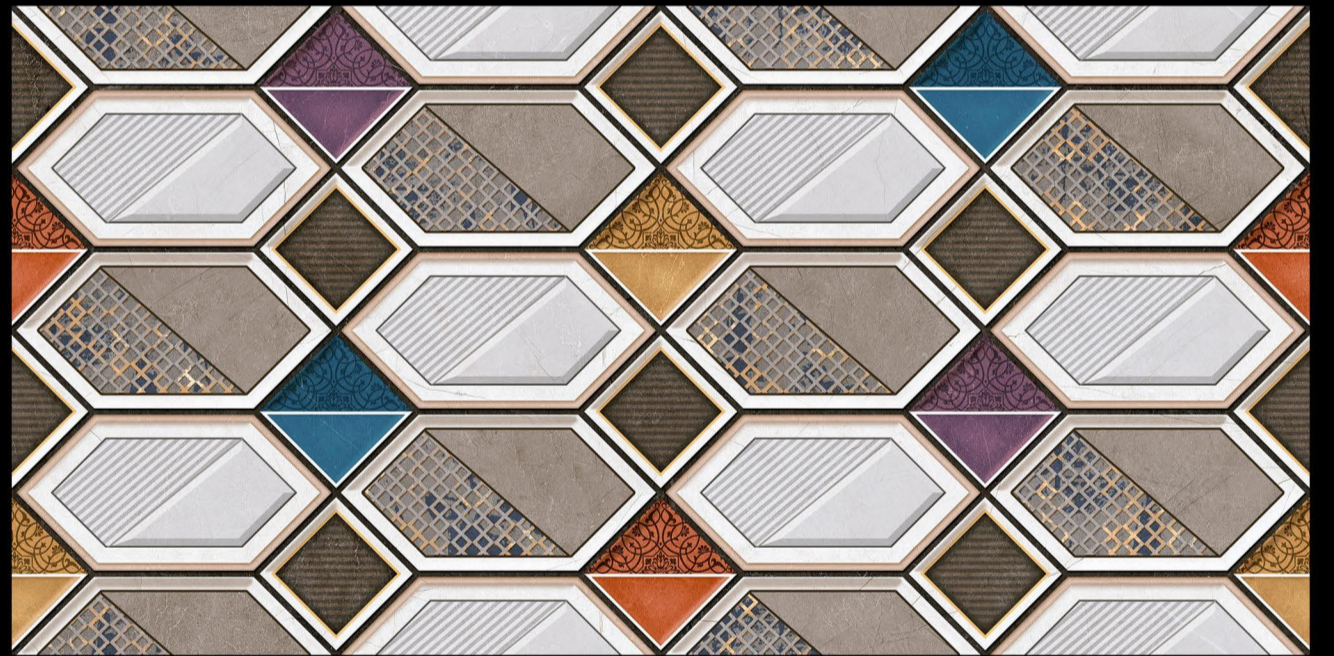
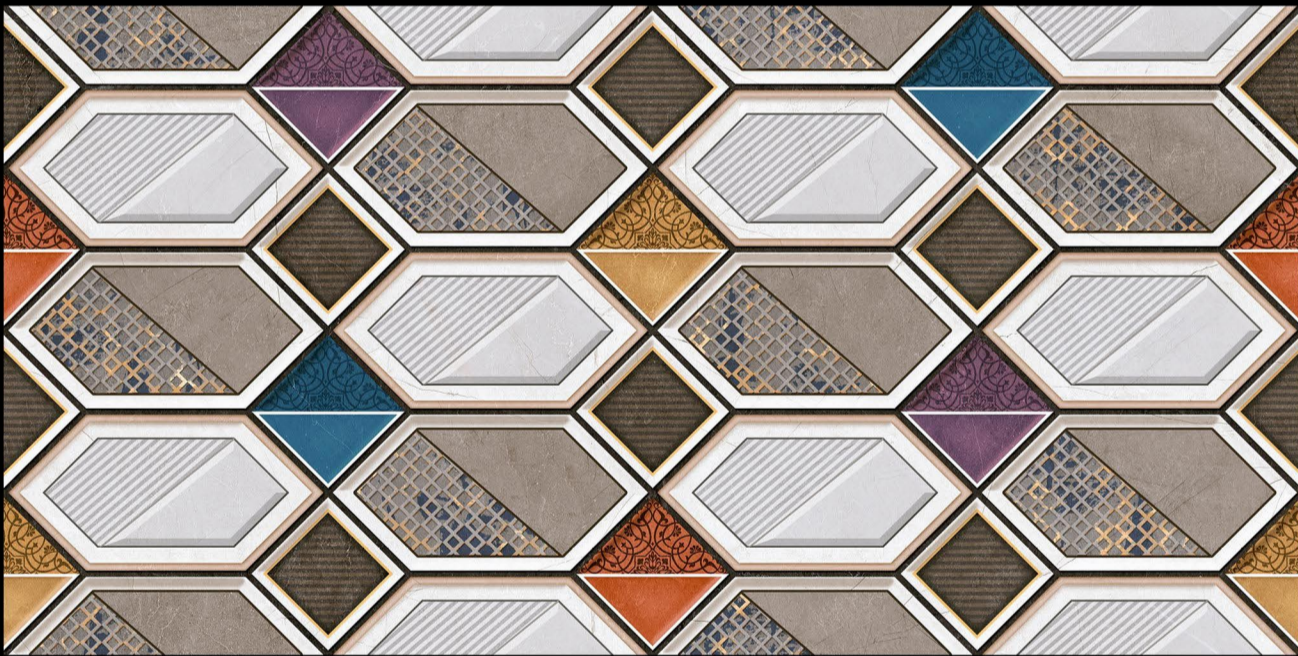

HL-2

HL-2

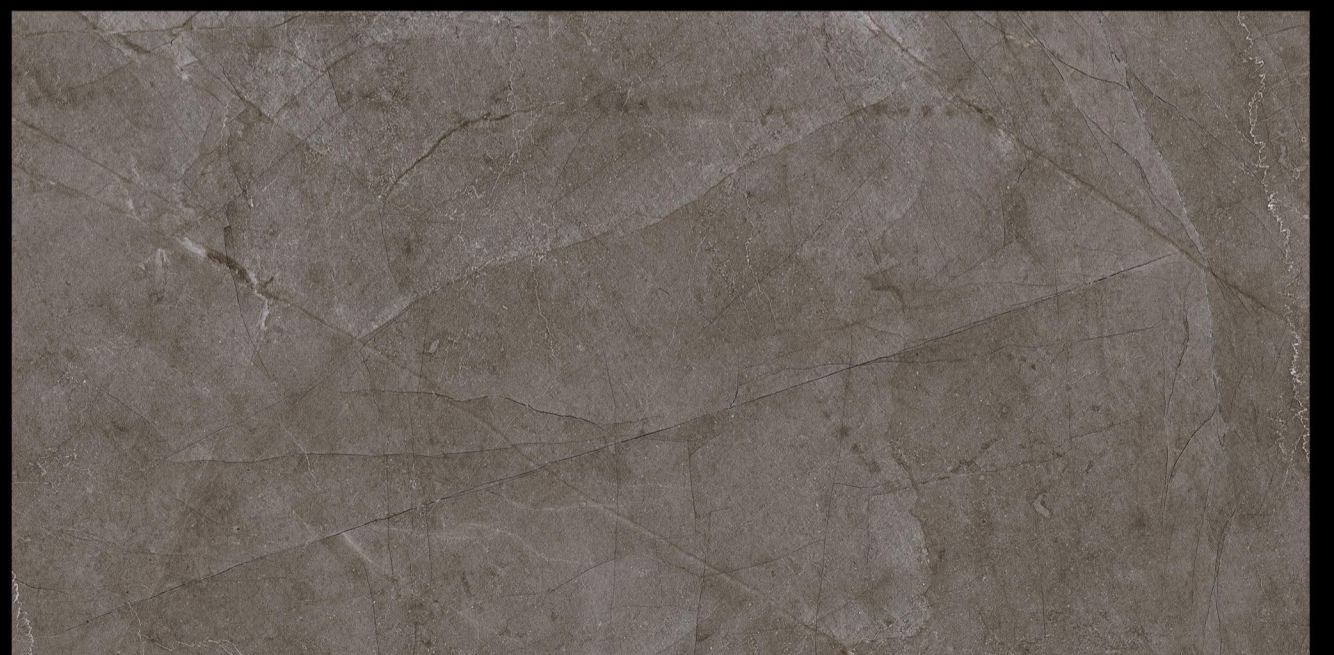

D





NEON TILE LLP

Corp. Office : G24, Siromany Business Center, B/h. Real Plaza,
8-A National Highway, Morbi-363 641. (Guj.) INDIA.

Call : +91 82382 31831

E : info@neontile.in

W : www.neontile.in

Follow Us :

